

SHEET 1 - VICINITY MAP

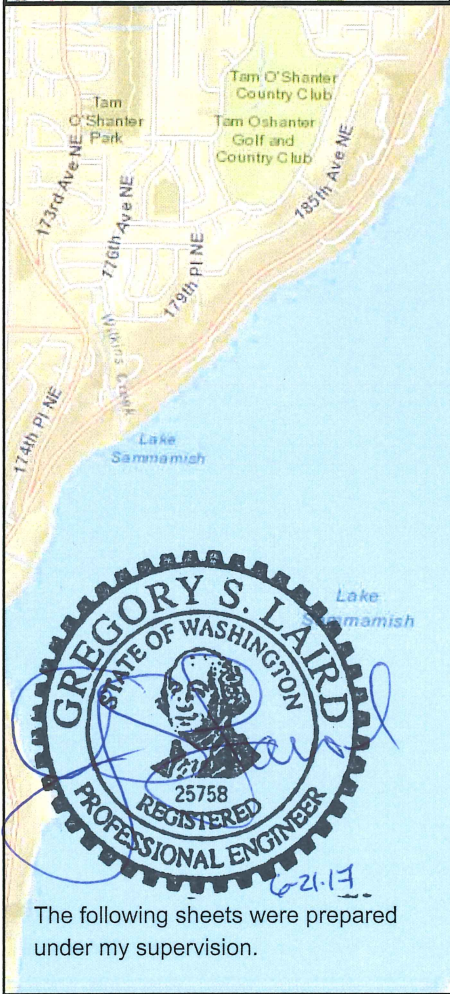

PROJECT SITE

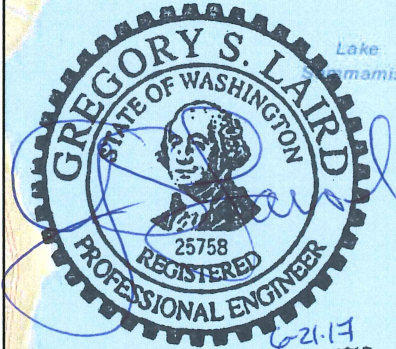

The following sheets were prepared under my supervision.

K:\project\32700\32794\CADD\GIS\MXD\JARPA-Sheet1_VicinityMap.mxd

Date: May 2017

APPLICANT: City of Sammamish
REFERENCE #:
ADJACENT PROPERTY OWNERS:
 See JARPA Attachment C

PURPOSE: Environmental Enhancement
LAT/LONG:
 47.6100N / -122.0703W
SITE LOCATION ADDRESS:
 Portions of Section 32,
 Township 25N, Range 06E

PROPOSED PROJECT:
 Zackuse Creek Fish Passage Project
WATERBODY: Zackuse Creek
NEAR: Sammamish
COUNTY: King **STATE:** WA
SHEET 1 OF 20

SHEET 2: ADJACENT PROPERTY OWNERS

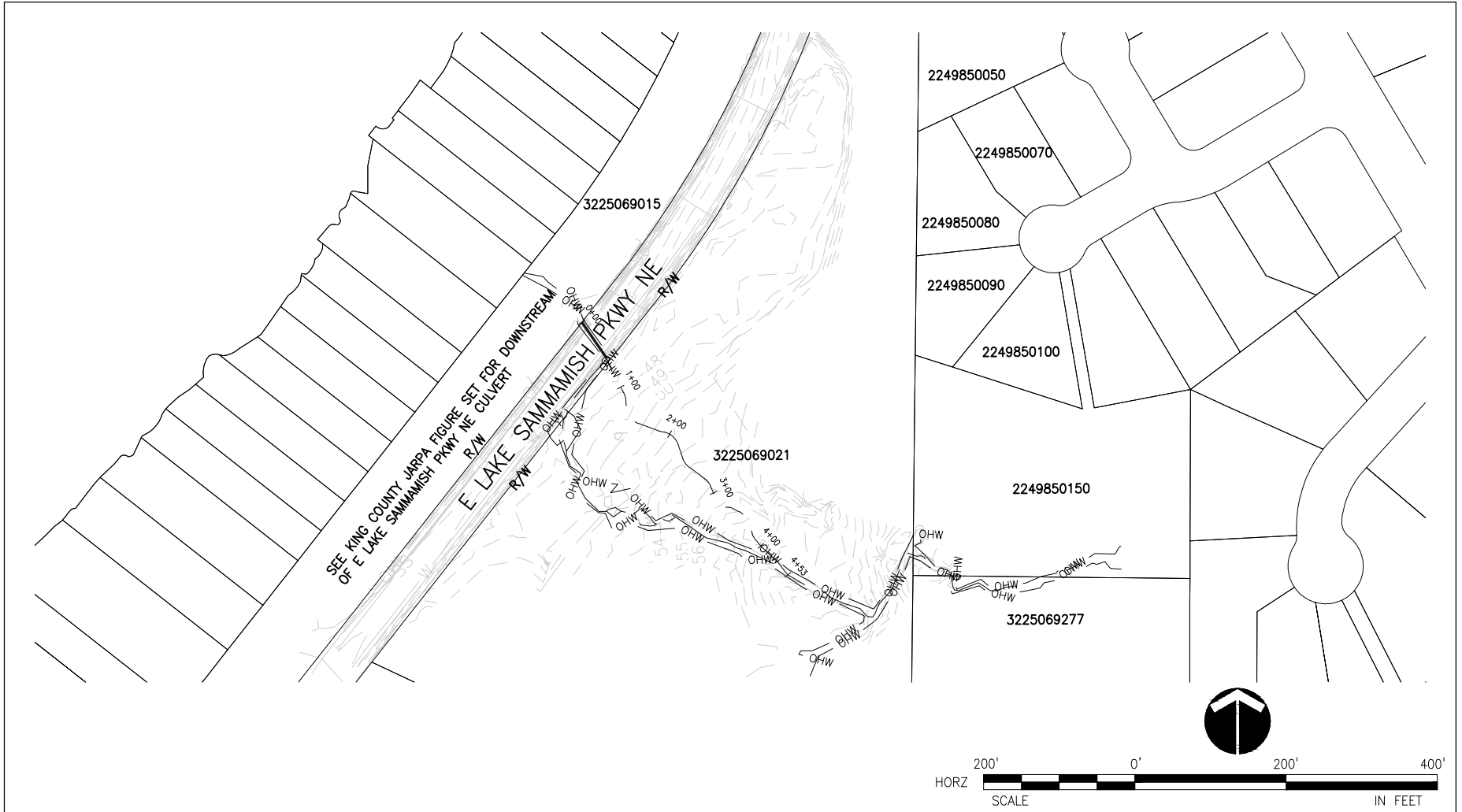

DATE: MAY 2017

APPLICANT: CITY OF SAMMAMISH

PURPOSE: ENVIRONMENTAL ENHANCEMENT

PROPOSED PROJECT: ZACKUSE CREEK FISH PASSAGE PROJECT

REFERENCE #:

LAT/LONG: 47.6100N / 122.0703W

ADJACENT PROPERTY OWNERS: SEE JARPA ATTACHMENT C

SITE LOCATION ADDRESS: PORTIONS OF SECTION 32, TOWNSHIP 25N, RANGE 06E

WATER BODY: LAKE SAMMAMISH/ZACKUSE CREEK
 NEAR: SAMMAMISH
 COUNTY: KING STATE: WA

SHEET 3: EXISTING CONDITIONS

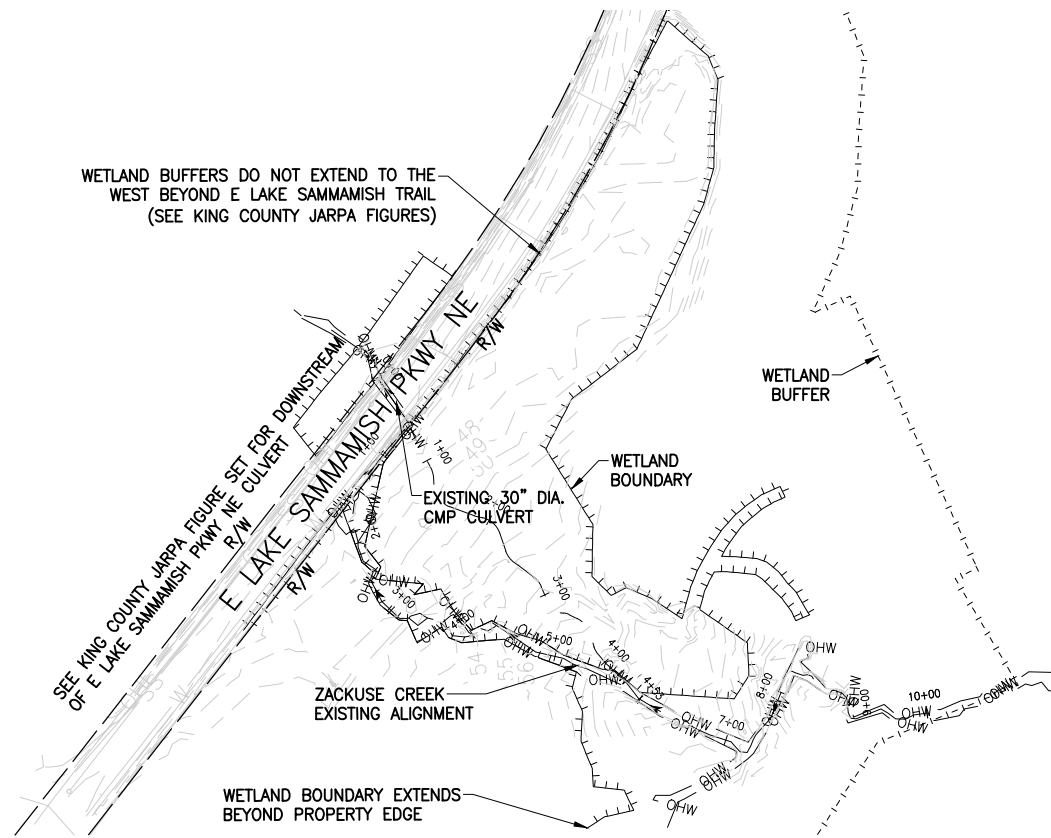

LEGEND

- +++++ WETLAND BOUNDARY
- - - - - WETLAND BUFFER

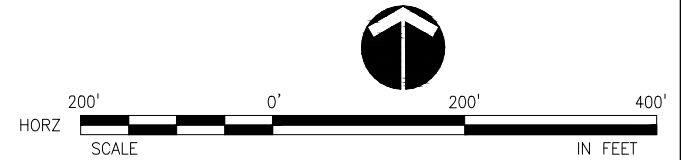

DATE: MAY 2017

APPLICANT: CITY OF SAMMAMISH

PURPOSE: ENVIRONMENTAL
ENHANCEMENT

PROPOSED PROJECT:
ZACKUSE CREEK FISH PASSAGE PROJECT

REFERENCE #:

LAT/LONG: 47.6100N / 122.0703W

ADJACENT PROPERTY OWNERS:
SEE JARPA ATTACHMENT C

SITE LOCATION ADDRESS:
PORTIONS OF SECTION 32,
TOWNSHIP 25N, RANGE 06E

WATER BODY: LAKE SAMMAMISH/ZACKUSE CREEK
NEAR: SAMMAMISH
COUNTY: KING STATE: WA

SHEET 4: SITE PLAN (1 OF 3)

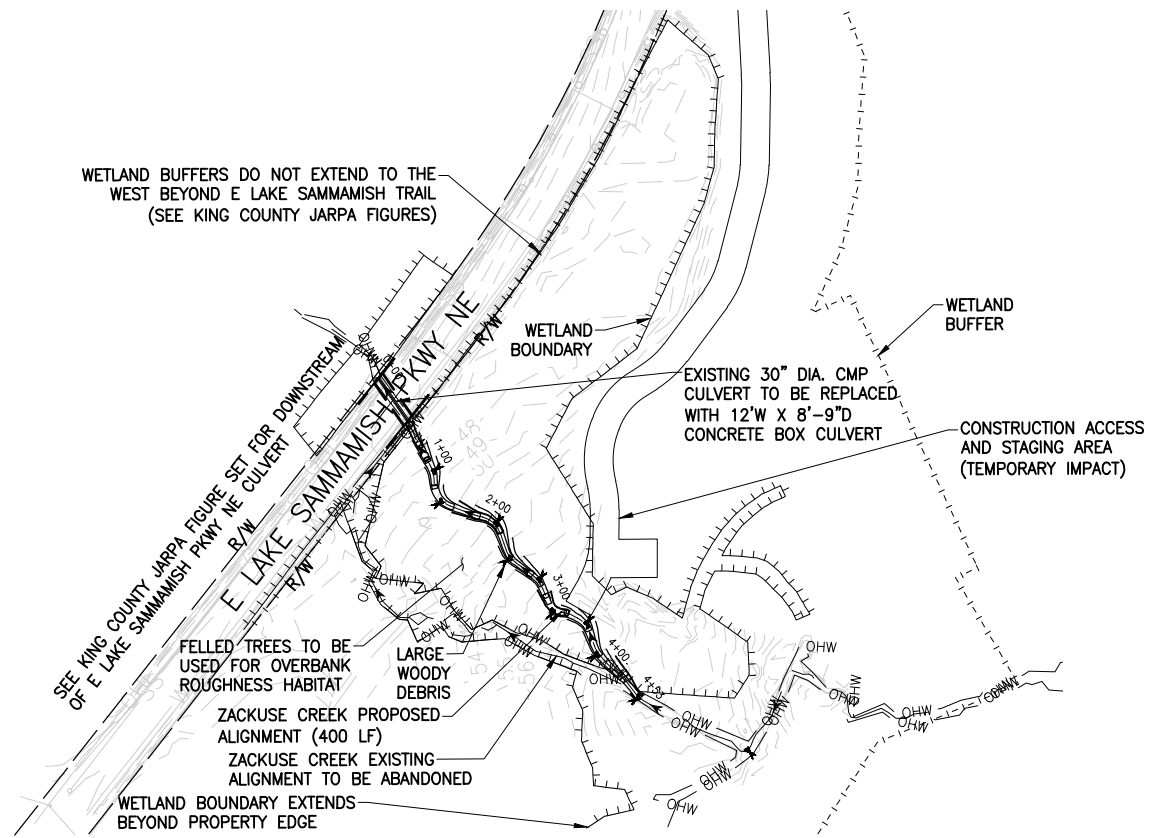

LEGEND

- +++++ WETLAND BOUNDARY
- - - - - WETLAND BUFFER

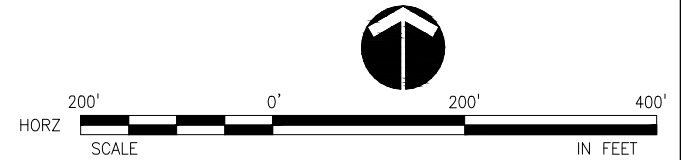

DATE: MAY 2017

APPLICANT: CITY OF SAMMAMISH

REFERENCE #:

ADJACENT PROPERTY OWNERS:
SEE JARPA ATTACHMENT C

PURPOSE: ENVIRONMENTAL
ENHANCEMENT

LAT/LONG: 47.6100N / 122.0703W

SITE LOCATION ADDRESS:
PORTIONS OF SECTION 32,
TOWNSHIP 25N, RANGE 06E

PROPOSED PROJECT:
ZACKUSE CREEK FISH PASSAGE PROJECT

WATER BODY: LAKE SAMMAMISH/ZACKUSE CREEK
NEAR: SAMMAMISH

COUNTY: KING STATE: WA

SHEET 5: SITE PLAN (2 OF 3)

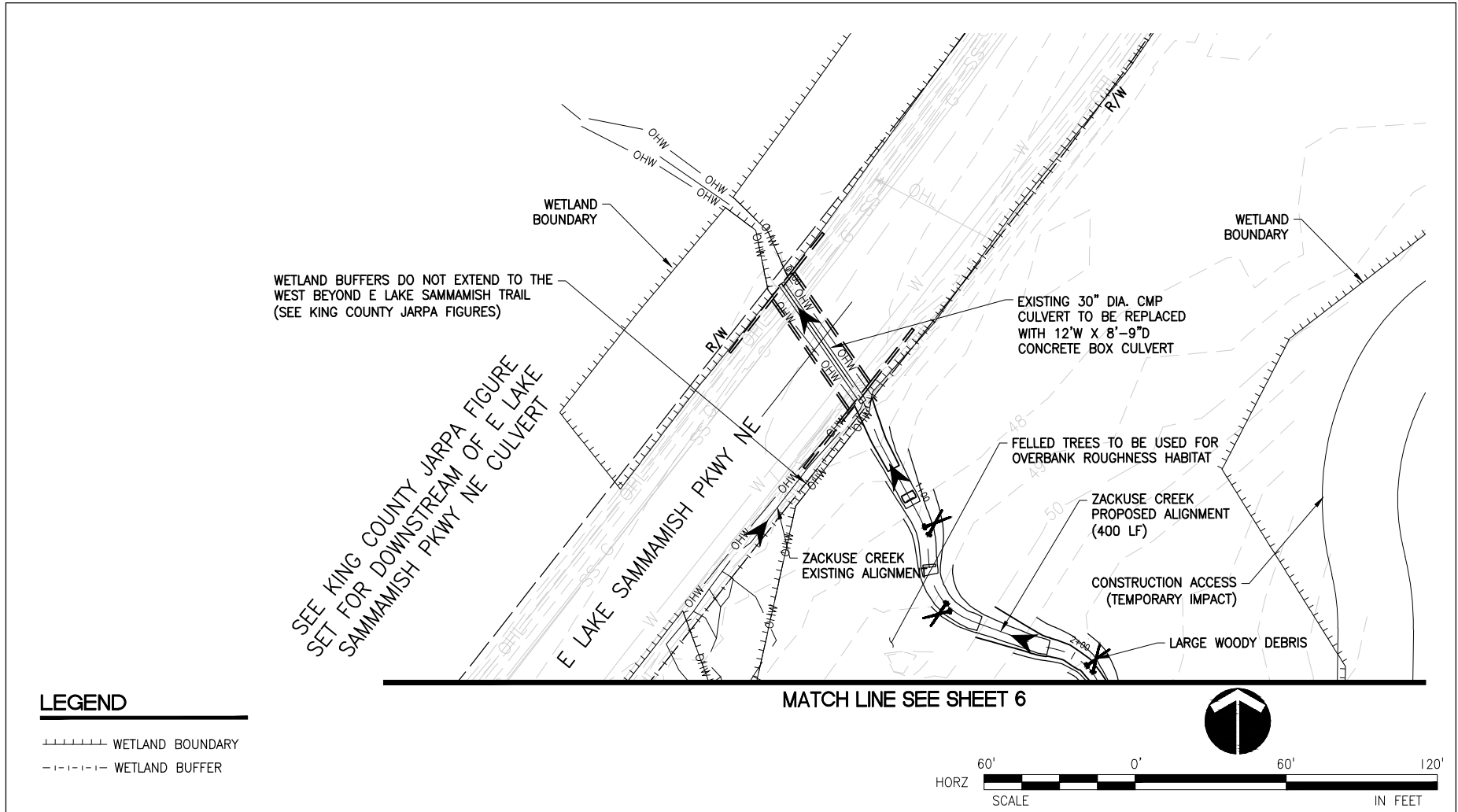

DATE: MAY 2017

APPLICANT: CITY OF SAMMAMISH

PURPOSE: ENVIRONMENTAL ENHANCEMENT

PROPOSED PROJECT: ZACKUSE CREEK FISH PASSAGE PROJECT

REFERENCE #:

LAT/LONG: 47.6100N / 122.0703W

ADJACENT PROPERTY OWNERS: SEE JARPA ATTACHMENT C

SITE LOCATION ADDRESS: PORTIONS OF SECTION 32, TOWNSHIP 25N, RANGE 06E

WATER BODY: LAKE SAMMAMISH/ZACKUSE CREEK NEAR: SAMMAMISH

COUNTY: KING STATE: WA

SHEET 6: SITE PLAN (3 OF 3)

MATCH LINE SEE SHEET 5

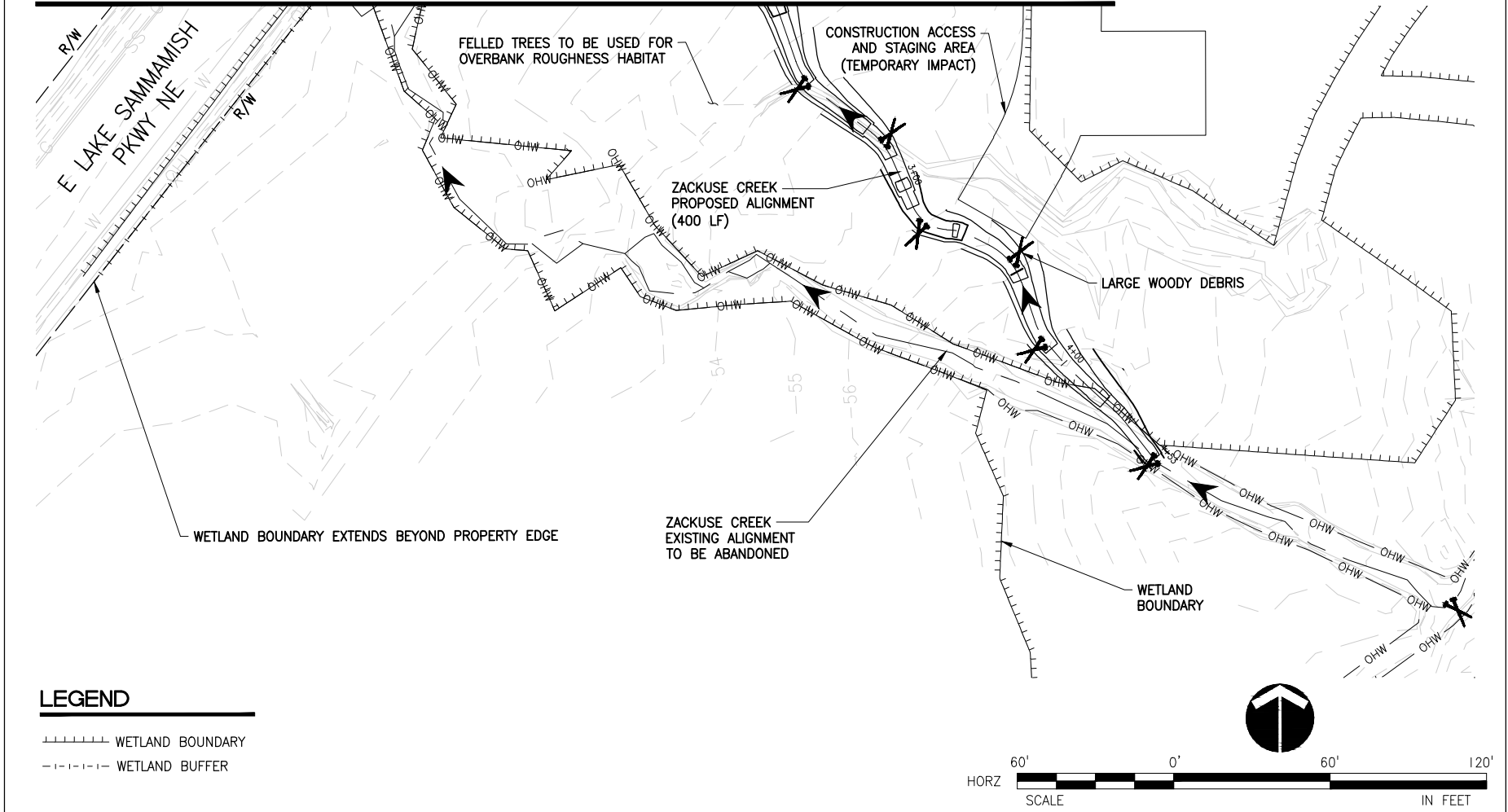

LEGEND

- WETLAND BOUNDARY
- - - - - WETLAND BUFFER



DATE: MAY 2017

APPLICANT: CITY OF SAMMAMISH

PURPOSE: ENVIRONMENTAL ENHANCEMENT

PROPOSED PROJECT: ZACKUSE CREEK FISH PASSAGE PROJECT

REFERENCE #:

LAT/LONG: 47.6100N / 122.0703W

ADJACENT PROPERTY OWNERS: SEE JARPA ATTACHMENT C

SITE LOCATION ADDRESS: PORTIONS OF SECTION 32, TOWNSHIP 25N, RANGE 06E

WATER BODY: LAKE SAMMAMISH/ZACKUSE CREEK
 NEAR: SAMMAMISH
 COUNTY: KING STATE: WA

SHEET 7: PROPOSED STREAM PROFILE

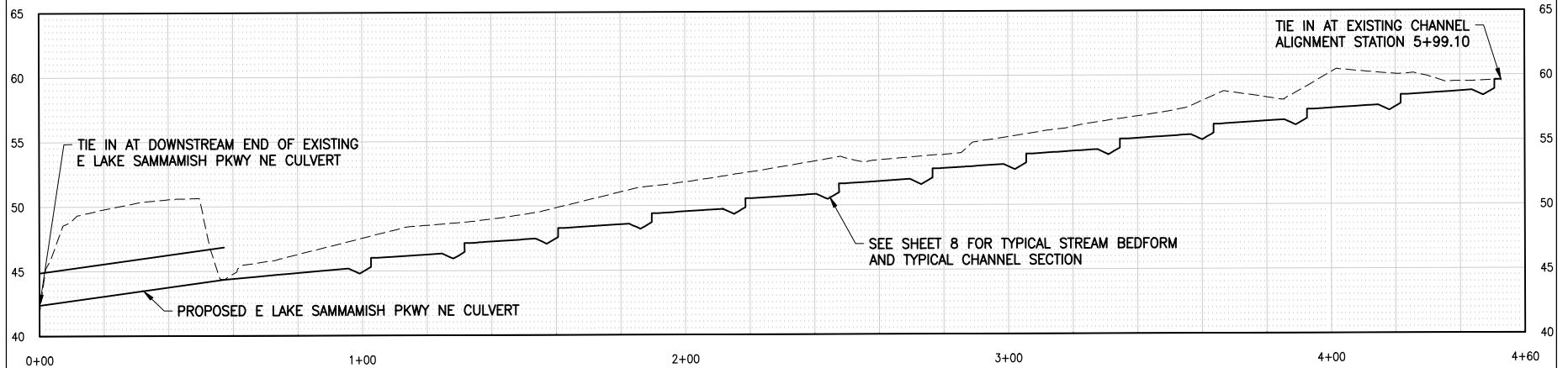

PROFILE AT ZACKUSE CREEK
PROPOSED REALIGNMENT CENTERLINE

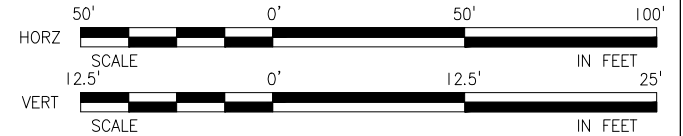

DATE: MAY 2017

APPLICANT: CITY OF SAMMAMISH

REFERENCE #:

ADJACENT PROPERTY OWNERS:
SEE JARPA ATTACHMENT C

PURPOSE: ENVIRONMENTAL
ENHANCEMENT

LAT/LONG: 47.6100N / 122.0703W

SITE LOCATION ADDRESS:
PORTIONS OF SECTION 32,
TOWNSHIP 25N, RANGE 06E

PROPOSED PROJECT:
ZACKUSE CREEK FISH PASSAGE PROJECT

WATER BODY: LAKE SAMMAMISH/ZACKUSE CREEK
NEAR: SAMMAMISH

COUNTY: KING STATE: WA

SHEET 8: TYPICAL STREAM BEDFORM AND TYPICAL CHANNEL SECTION

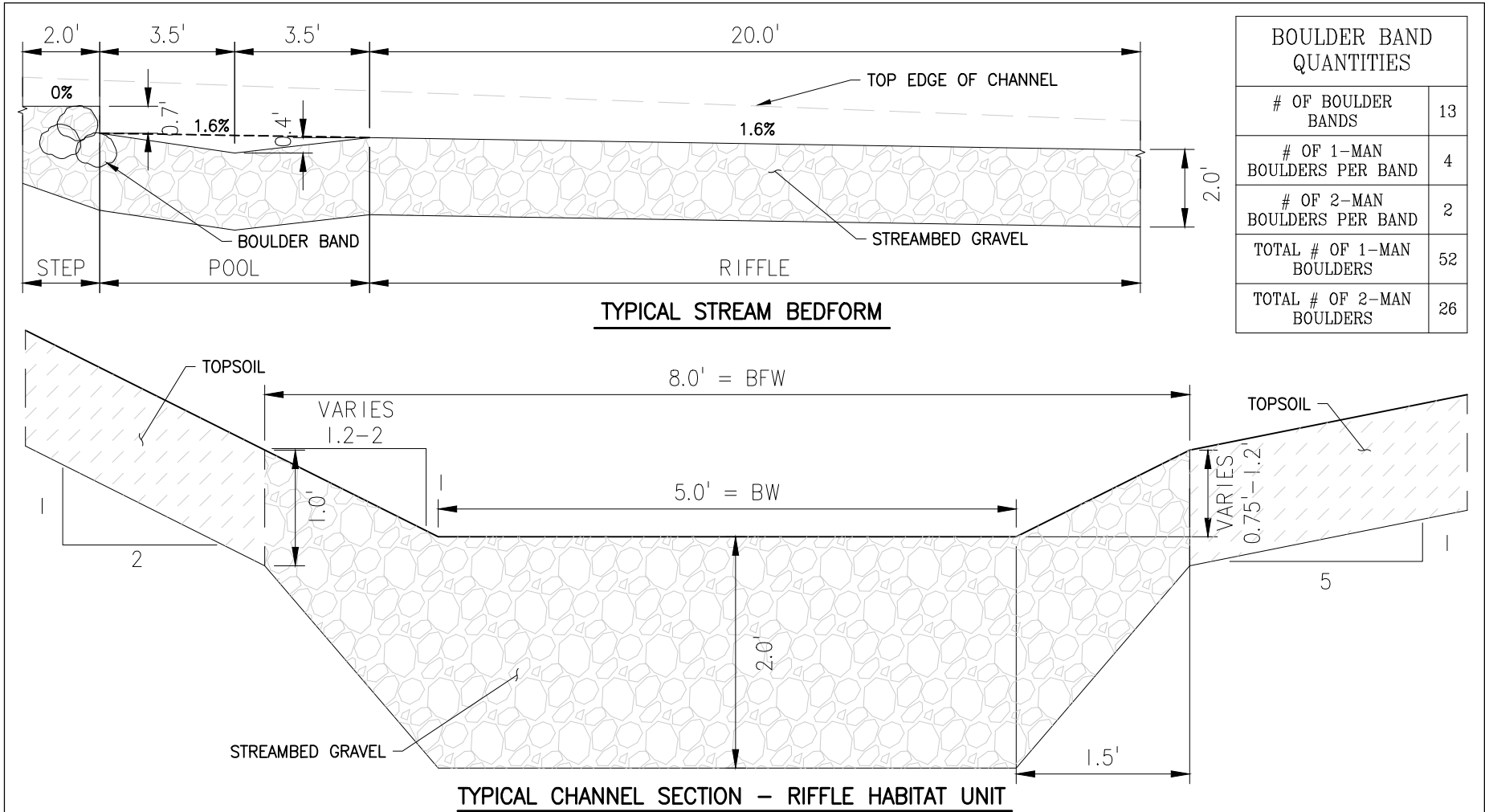

DATE: MAY 2017

APPLICANT: CITY OF SAMMAMISH

PURPOSE: ENVIRONMENTAL ENHANCEMENT

PROPOSED PROJECT: ZACKUSE CREEK FISH PASSAGE PROJECT

REFERENCE #:

LAT/LONG: 47.6100N / 122.0703W

WATER BODY: LAKE SAMMAMISH/ZACKUSE CREEK
NEAR: SAMMAMISH

ADJACENT PROPERTY OWNERS:
SEE JARPA ATTACHMENT C

SITE LOCATION ADDRESS:
PORTIONS OF SECTION 32,
TOWNSHIP 25N, RANGE 06E

COUNTY: KING STATE: WA

SHEET 9: CULVERT PLAN

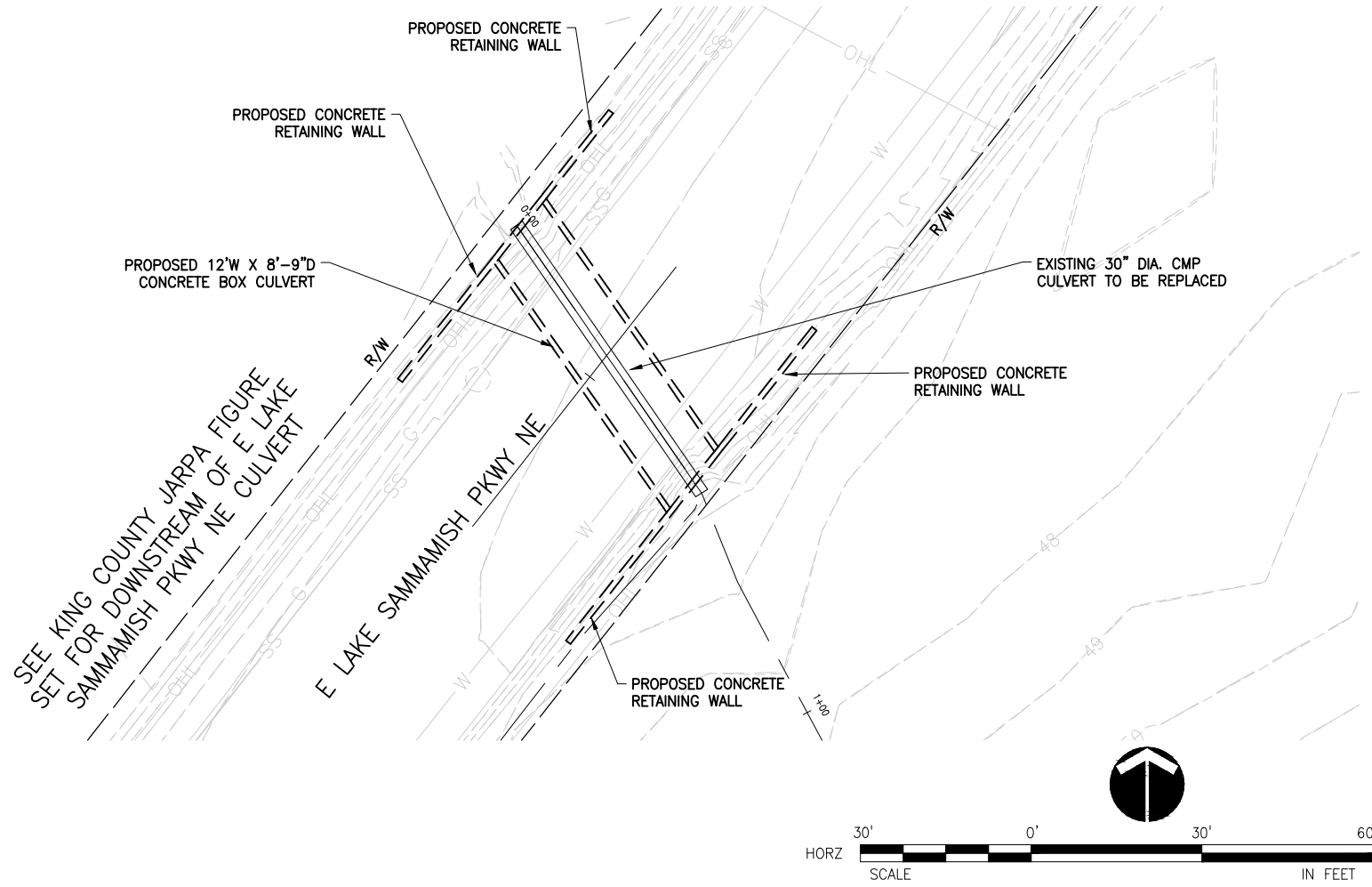

DATE: MAY 2017

<p>APPLICANT: CITY OF SAMMAMISH</p> <p>REFERENCE #:</p> <p>ADJACENT PROPERTY OWNERS: SEE JARPA ATTACHMENT C</p>	<p>PURPOSE: ENVIRONMENTAL ENHANCEMENT</p> <p>LAT/LONG: 47.6100N / 122.0703W</p> <p>SITE LOCATION ADDRESS: PORTIONS OF SECTION 32, TOWNSHIP 25N, RANGE 06E</p>	<p>PROPOSED PROJECT: ZACKUSE CREEK FISH PASSAGE PROJECT</p> <p>WATER BODY: LAKE SAMMAMISH/ZACKUSE CREEK</p> <p>NEAR: SAMMAMISH</p> <p>COUNTY: KING STATE: WA</p>
---	---	--

SHEET 10: CULVERT DETAILS (TYPICAL SECTION AND PROFILE)

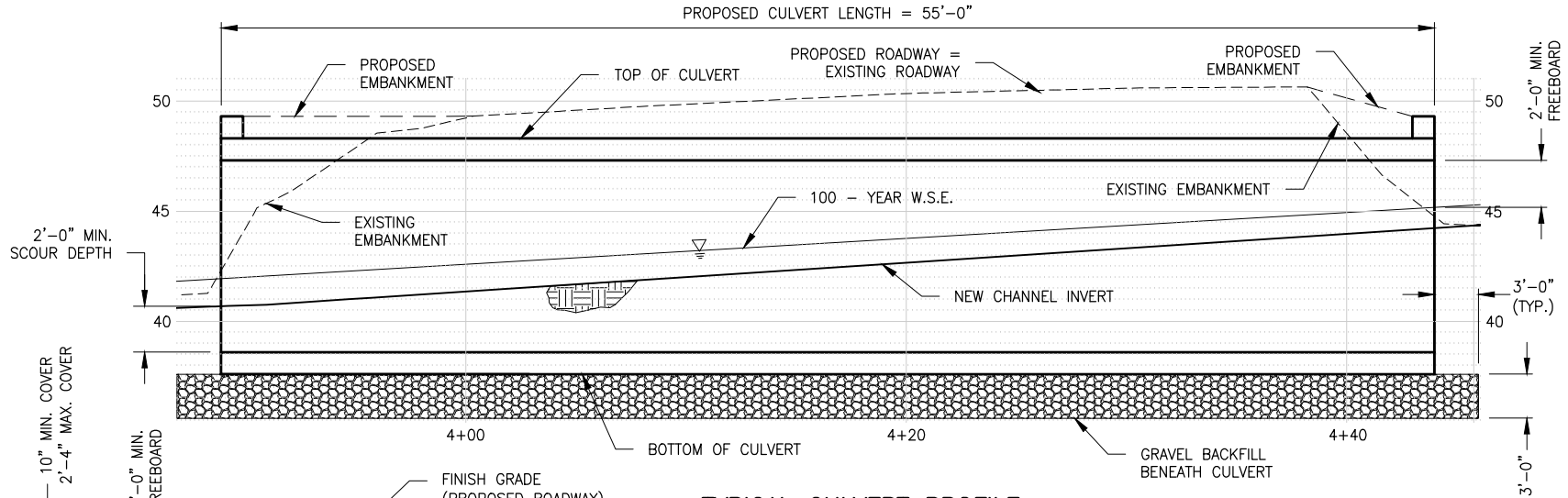

TYPICAL CULVERT PROFILE

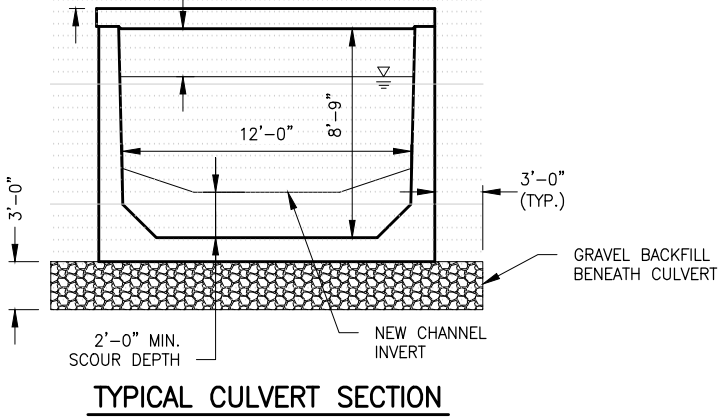

TYPICAL CULVERT SECTION

DATE: MAY 2017

APPLICANT: CITY OF SAMMAMISH

PURPOSE: ENVIRONMENTAL ENHANCEMENT

PROPOSED PROJECT: ZACKUSE CREEK FISH PASSAGE PROJECT

REFERENCE #:

LAT/LONG: 47.6100N / 122.0703W

ADJACENT PROPERTY OWNERS: SEE JARPA ATTACHMENT C

SITE LOCATION ADDRESS: PORTIONS OF SECTION 32, TOWNSHIP 25N, RANGE 06E

WATER BODY: LAKE SAMMAMISH/ZACKUSE CREEK
NEAR: SAMMAMISH
COUNTY: KING STATE: WA

SHEET 11: CULVERT CONSTRUCTION STAGING PLAN

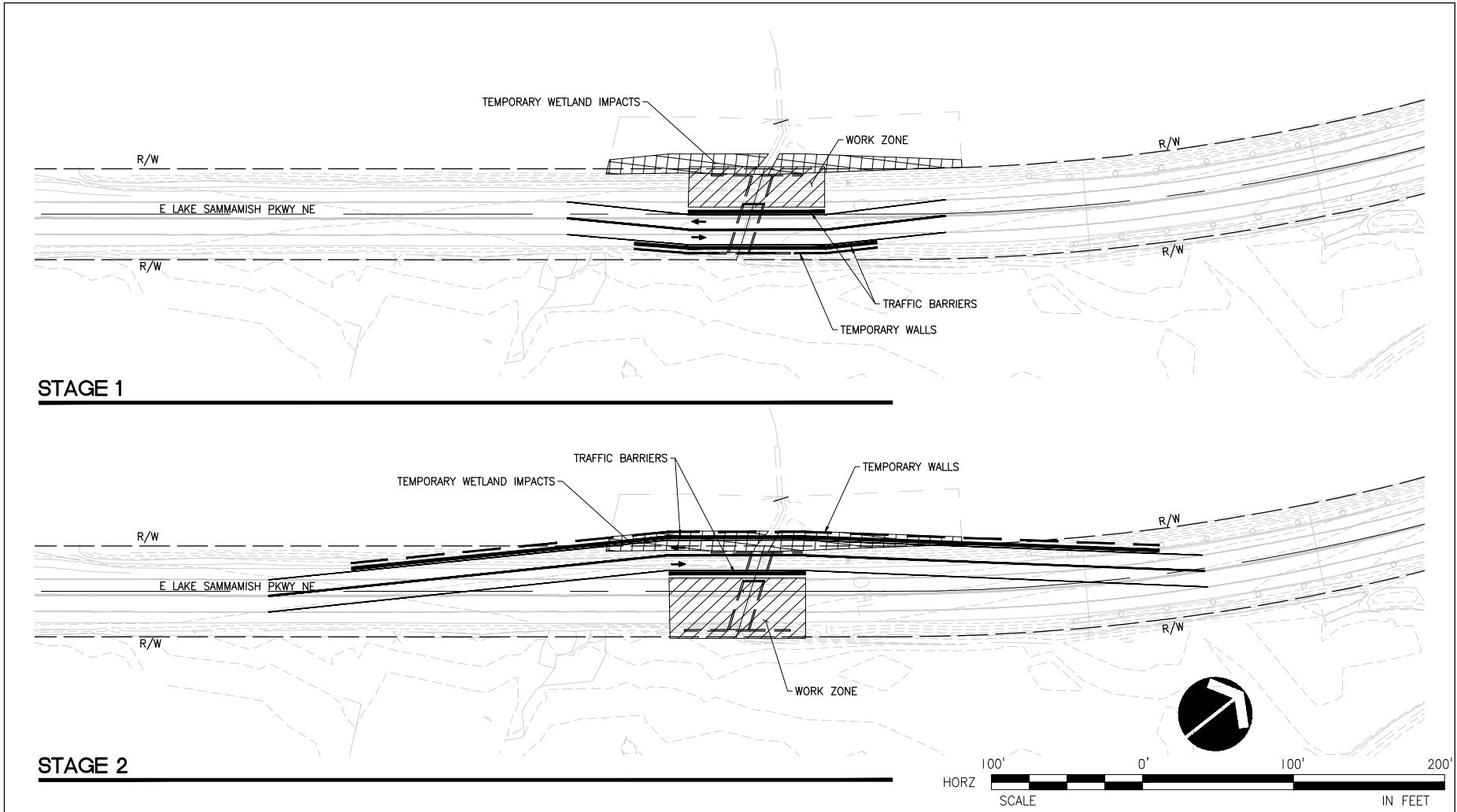

DATE: MAY 2017

APPLICANT: CITY OF SAMMAMISH

REFERENCE #:

ADJACENT PROPERTY OWNERS:
SEE JARPA ATTACHMENT C

PURPOSE: ENVIRONMENTAL ENHANCEMENT

LAT/LONG: 47.6100N / 122.0703W

SITE LOCATION ADDRESS:
PORTIONS OF SECTION 32,
TOWNSHIP 25N, RANGE 06E

PROPOSED PROJECT:
ZACKUSE CREEK FISH PASSAGE PROJECT

WATER BODY: LAKE SAMMAMISH/ZACKUSE CREEK
NEAR: SAMMAMISH
COUNTY: KING STATE: WA

11 OF 20

SHEET 12: WETLAND AND STREAM AREAS OF IMPACT (1 OF 3)

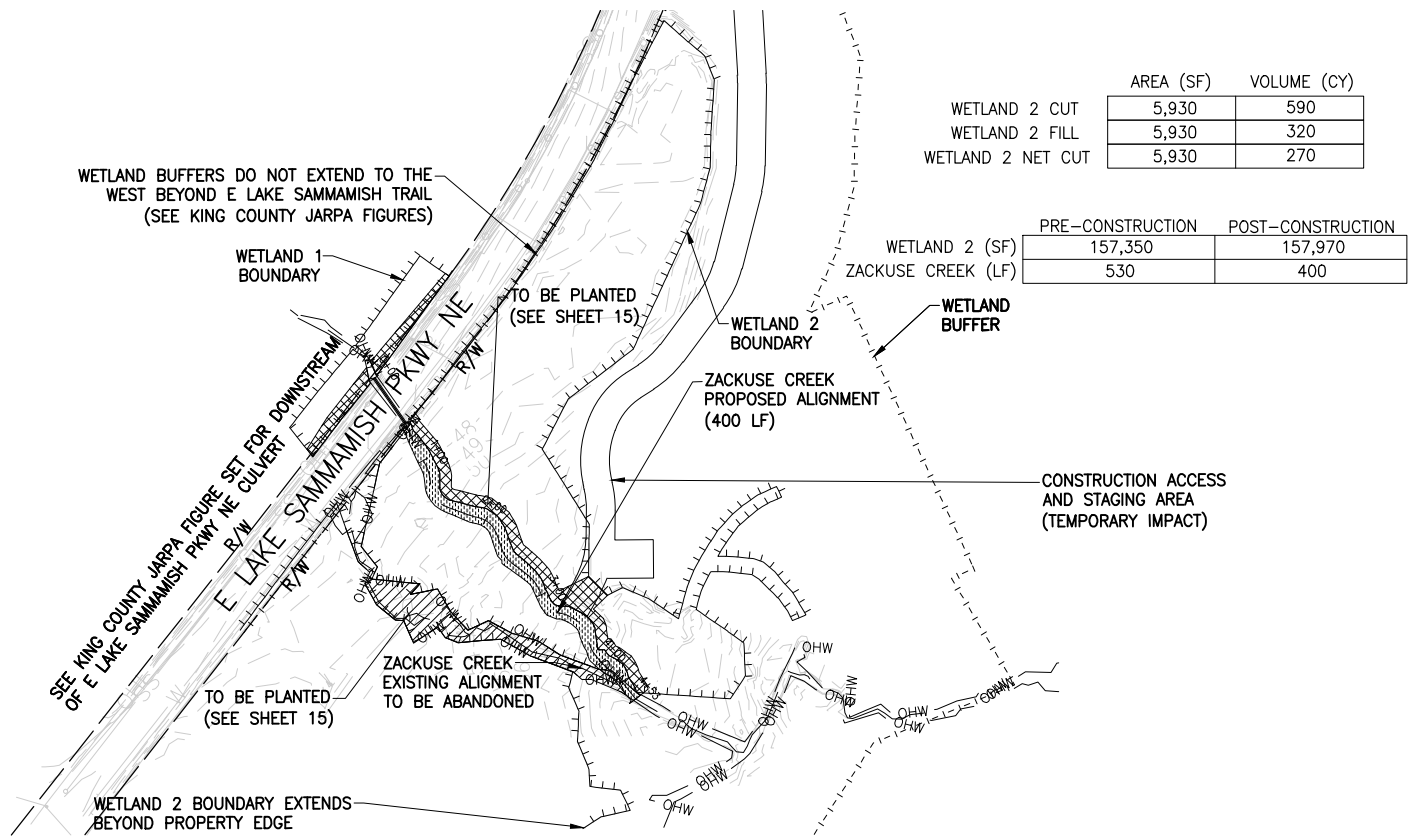

	AREA (SF)	VOLUME (CY)
WETLAND 2 CUT	5,930	590
WETLAND 2 FILL	5,930	320
WETLAND 2 NET CUT	5,930	270

	PRE-CONSTRUCTION	POST-CONSTRUCTION
WETLAND 2 (SF)	157,350	157,970
ZACKUSE CREEK (LF)	530	400

LEGEND

- WETLAND CONVERSION IN ABANDONED STREAM CHANNEL (6,090 SF)
- NEW STREAM ALIGNMENT - PERMENANT WETLAND COVERSION (5,930 SF)
- TEMPORARY WETLAND IMPACTS (7,950 SF)
- WETLAND BOUNDARY
- WETLAND BUFFER



DATE: MAY 2017

APPLICANT: CITY OF SAMMAMISH

REFERENCE #:

ADJACENT PROPERTY OWNERS:
SEE JARPA ATTACHMENT C

PURPOSE: ENVIRONMENTAL ENHANCEMENT

LAT/LONG: 47.6100N / 122.0703W

SITE LOCATION ADDRESS:
PORTIONS OF SECTION 32,
TOWNSHIP 25N, RANGE 06E

PROPOSED PROJECT:
ZACKUSE CREEK FISH PASSAGE PROJECT

WATER BODY: LAKE SAMMAMISH/ZACKUSE CREEK

NEAR: SAMMAMISH

COUNTY: KING STATE: WA

SHEET 13: WETLAND AND STREAM AREAS OF IMPACT (2 OF 3)

	AREA (SF)	VOLUME (CY)
WETLAND 2 CUT	5,930	590
WETLAND 2 FILL	5,930	320
WETLAND 2 NET CUT	5,930	270

	PRE-CONSTRUCTION	POST-CONSTRUCTION
WETLAND 2 (SF)	157,350	157,970
ZACKUSE CREEK (LF)	530	400

WETLAND BUFFERS DO NOT EXTEND TO THE WEST BEYOND E LAKE SAMMAMISH TRAIL (SEE KING COUNTY JARPA FIGURES)

SEE KING COUNTY JARPA FIGURE SET FOR DOWNSTREAM OF E LAKE SAMMAMISH PKWY NE CULVERT

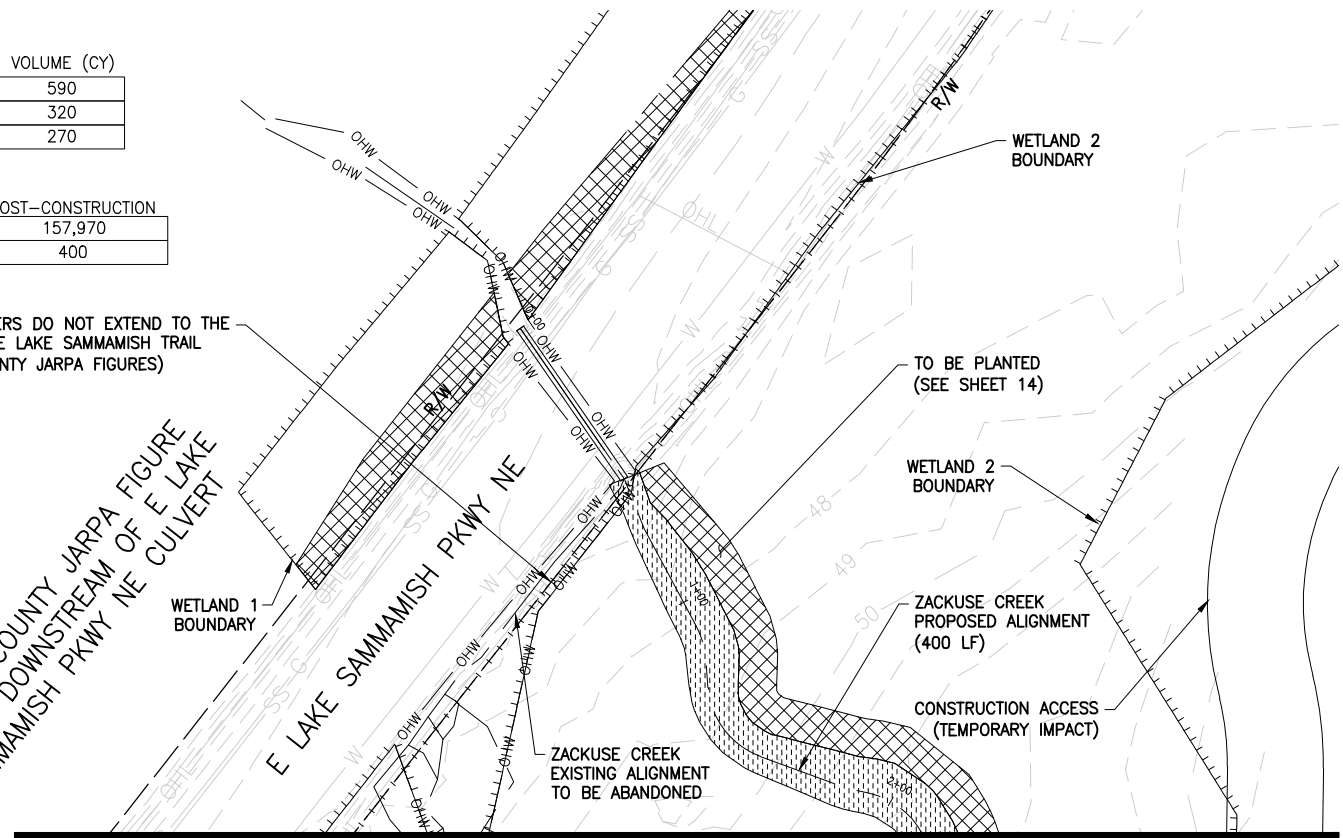

LEGEND

- WETLAND CONVERSION IN ABANDONED STREAM CHANNEL (6,090 SF)
- NEW STREAM ALIGNMENT - PERMENANT WETLAND COVERSION (5,930 SF)
- TEMPORARY WETLAND IMPACTS (7,950 SF)
- WETLAND BOUNDARY
- WETLAND BUFFER

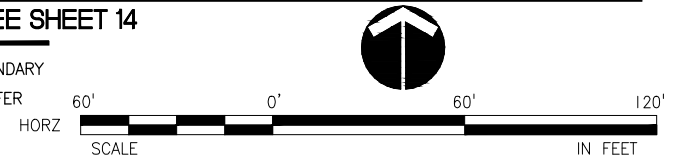

MATCH LINE SEE SHEET 14

DATE: MAY 2017

APPLICANT: CITY OF SAMMAMISH

PURPOSE: ENVIRONMENTAL ENHANCEMENT

PROPOSED PROJECT: ZACKUSE CREEK FISH PASSAGE PROJECT

REFERENCE #:

LAT/LONG: 47.6100N / 122.0703W

ADJACENT PROPERTY OWNERS: SEE JARPA ATTACHMENT C

SITE LOCATION ADDRESS: PORTIONS OF SECTION 32, TOWNSHIP 25N, RANGE 06E

WATER BODY: LAKE SAMMAMISH/ZACKUSE CREEK
NEAR: SAMMAMISH
COUNTY: KING STATE: WA

SHEET 14: WETLAND AND STREAM AREAS OF IMPACT (3 OF 3)

MATCH LINE SEE SHEET 13

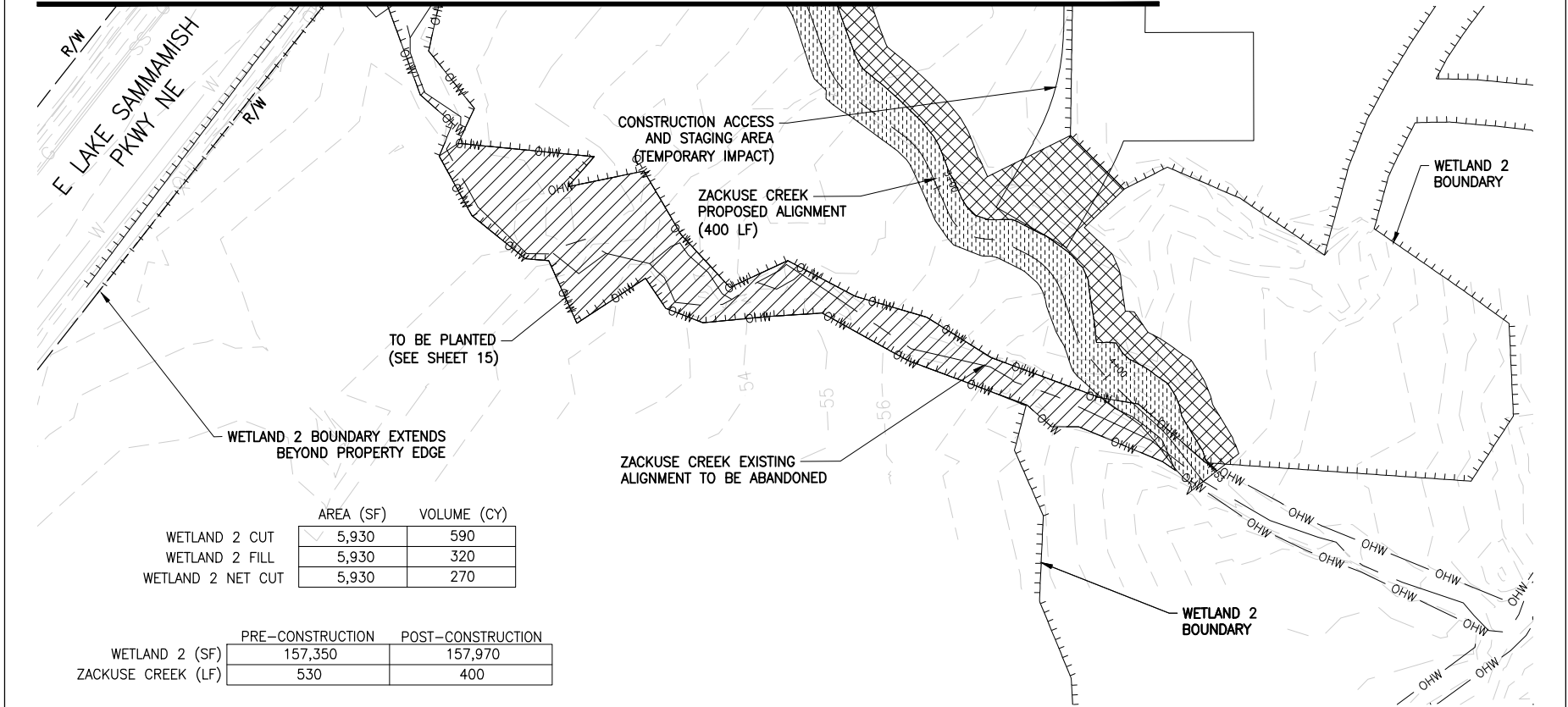

TO BE PLANTED
(SEE SHEET 15)





WETLAND 2 BOUNDARY EXTENDS
BEYOND PROPERTY EDGE



ZACKUSE CREEK EXISTING
ALIGNMENT TO BE ABANDONED

	AREA (SF)	VOLUME (CY)
WETLAND 2 CUT	5,930	590
WETLAND 2 FILL	5,930	320
WETLAND 2 NET CUT	5,930	270

	PRE-CONSTRUCTION	POST-CONSTRUCTION
WETLAND 2 (SF)	157,350	157,970
ZACKUSE CREEK (LF)	530	400

LEGEND

 WETLAND CONVERSION IN ABANDONED STREAM CHANNEL (6,090 SF)	 NEW STREAM ALIGNMENT - PERMENANT WETLAND CONVERSION (5,930 SF)	 TEMPORARY WETLAND IMPACTS (7,950 SF)	 WETLAND BOUNDARY  WETLAND BUFFER
--	---	--	--

DATE: MAY 2017

APPLICANT: CITY OF SAMMAMISH

REFERENCE #:

ADJACENT PROPERTY OWNERS:
SEE JARPA ATTACHMENT C

PURPOSE: ENVIRONMENTAL
ENHANCEMENT

LAT/LONG: 47.6100N / 122.0703W

SITE LOCATION ADDRESS:
PORTIONS OF SECTION 32,
TOWNSHIP 25N, RANGE 06E

PROPOSED PROJECT:
ZACKUSE CREEK FISH PASSAGE PROJECT

WATER BODY: LAKE SAMMAMISH/ZACKUSE CREEK
NEAR: SAMMAMISH
COUNTY: KING STATE: WA

SHEET 15: LANDSCAPE PLAN

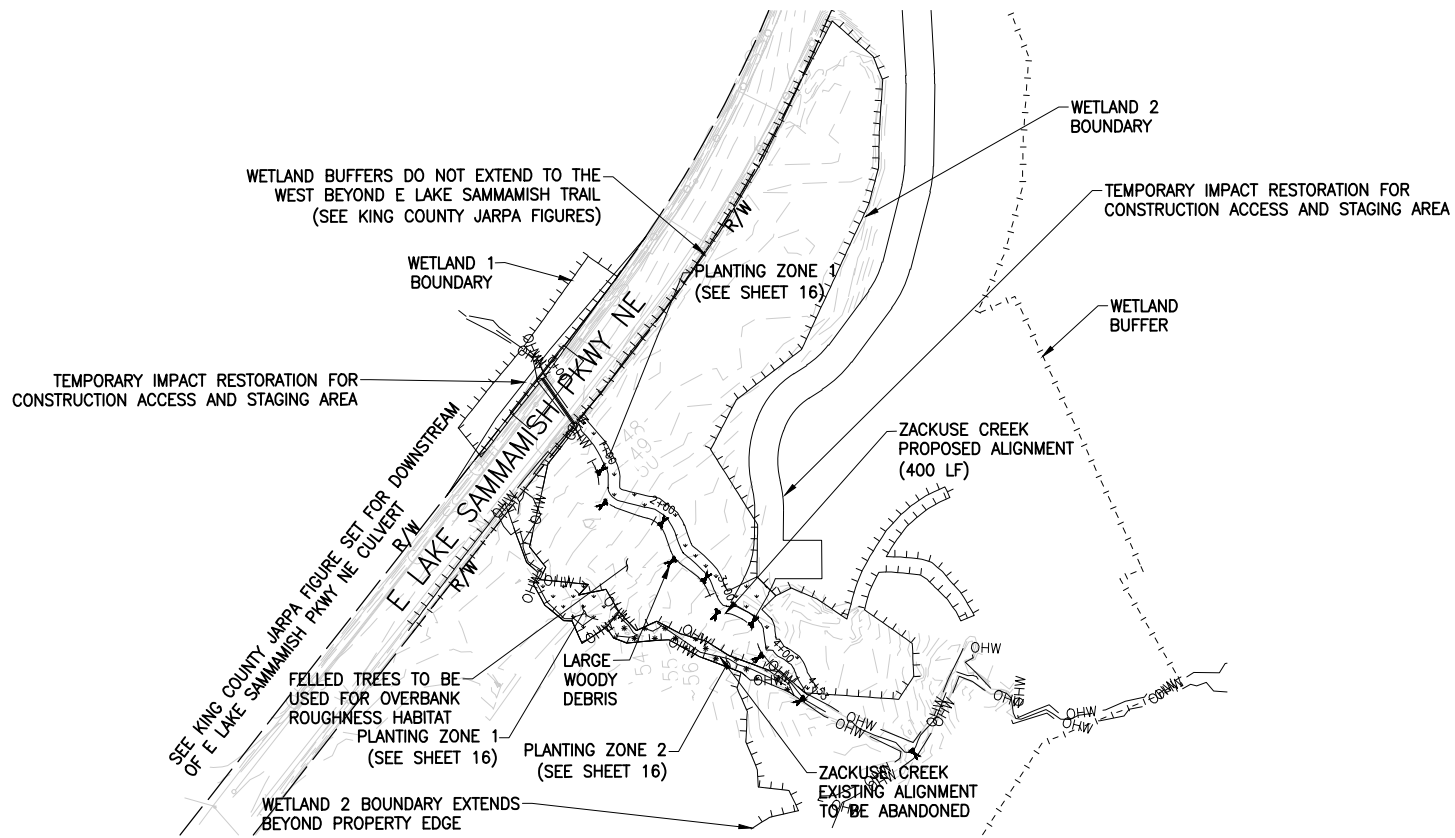

LEGEND

- ▽ ▽ ▽ PLANTING ZONE 1 (SEE SHEET 16)
- * * * PLANTING ZONE 2 (SEE SHEET 16)
- WETLAND BOUNDARY
- - - - - WETLAND BUFFER

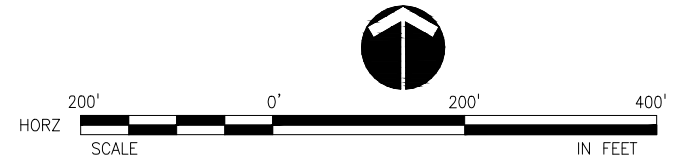

DATE: MAY 2017

APPLICANT: CITY OF SAMMAMISH

PURPOSE: ENVIRONMENTAL ENHANCEMENT

PROPOSED PROJECT: ZACKUSE CREEK FISH PASSAGE PROJECT

REFERENCE #:

LAT/LONG: 47.6100N / 122.0703W

ADJACENT PROPERTY OWNERS: SEE JARPA ATTACHMENT C

SITE LOCATION ADDRESS: PORTIONS OF SECTION 32, TOWNSHIP 25N, RANGE 06E

WATER BODY: LAKE SAMMAMISH/ZACKUSE CREEK
 NEAR: SAMMAMISH
 COUNTY: KING STATE: WA

SHEET 16: TREE AND SHRUB PLANTING SCHEDULE (SEE SHEET 15 FOR PLANTING AREAS)

Symbol	Common Name	Scientific Name	Size	Spacing On Center	Percent (%)
Zone 1	Trees				% of Trees
	Western red cedar	<i>Thuja plicata</i>	1 gallon	10'	75
	Black Cottonwood	<i>Populus balsamifera spp. trichocarpa</i>	Live stake	10'	25
	Shrubs				% of Shrubs
	Salmonberry	<i>Rubus spectabilis</i>	1 gallon	4'	50
	Pacific ninebark	<i>Physocarpus capitatus</i>	1 gallon	4'	50
Zone 2	Trees				% of Trees
	Black Cottonwood	<i>Populus balsamifera spp. trichocarpa</i>	Live stake (>0.75 inch diam.)	8'	50
	Pacific willow	<i>Salix lucia spp. lasiandra</i>	Live stake (>0.75 inch diam.)	8'	50
	Shrubs				% of Shrubs
	Red osier dogwood	<i>Cornus sericea</i>	Live stake	4'	100

1. The planting area includes the entire ground surface within the abandoned channel in Zone 2, and the entire sparsely vegetated sediment deposition area in Zone 1 as delineated by the former OHWM boundaries.

2. Trees and shrubs will be planted immediately following the rerouting of Zackuse Creek.

3. Plant live stakes using a planting bar in gravelly areas in Zone 2 to minimize damage to stems during installation.

DATE: MAY 2017

APPLICANT: CITY OF SAMMAMISH

REFERENCE #:

ADJACENT PROPERTY OWNERS:
SEE JARPA ATTACHMENT C

PURPOSE: ENVIRONMENTAL
ENHANCEMENT

LAT/LONG: 47.6100N / 122.0703W

SITE LOCATION ADDRESS:
PORTIONS OF SECTION 32,
TOWNSHIP 25N, RANGE 06E

PROPOSED PROJECT:
ZACKUSE CREEK FISH PASSAGE PROJECT

WATER BODY: LAKE SAMMAMISH/ZACKUSE CREEK

NEAR: SAMMAMISH

COUNTY: KING STATE: WA

SHEET 17: BANK STABILIZATION DETAILS

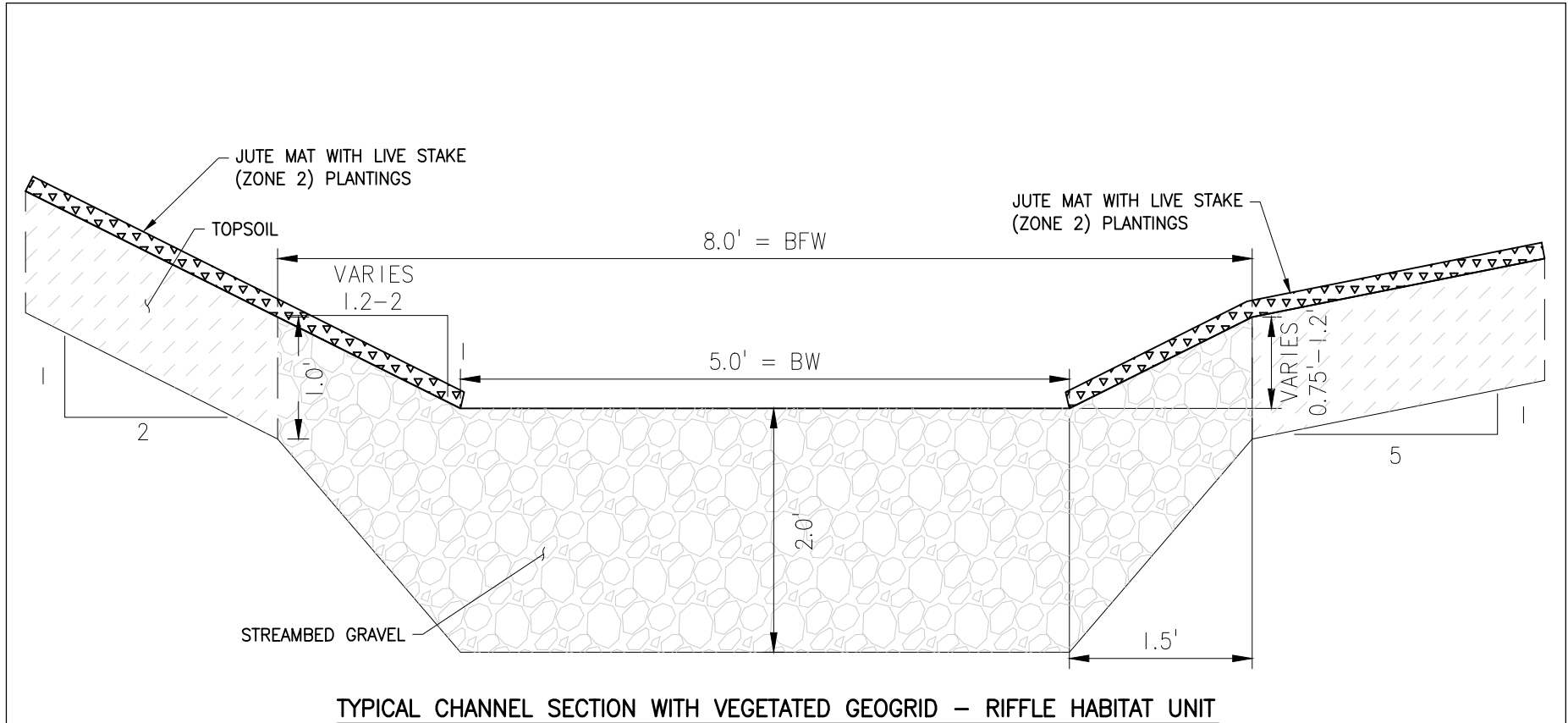

DATE: MAY 2017

APPLICANT: CITY OF SAMMAMISH

PURPOSE: ENVIRONMENTAL
ENHANCEMENT

PROPOSED PROJECT:
ZACKUSE CREEK FISH PASSAGE PROJECT

REFERENCE #:

LAT/LONG: 47.6100N / 122.0703W

ADJACENT PROPERTY OWNERS:
SEE JARPA ATTACHMENT C

SITE LOCATION ADDRESS:
PORTIONS OF SECTION 32,
TOWNSHIP 25N, RANGE 06E

WATER BODY: LAKE SAMMAMISH/ZACKUSE CREEK
NEAR: SAMMAMISH
COUNTY: KING STATE: WA

SHEET 18: TEMPORARY EROSION AND SEDIMENT CONTROL (TESC) (1 OF 3)

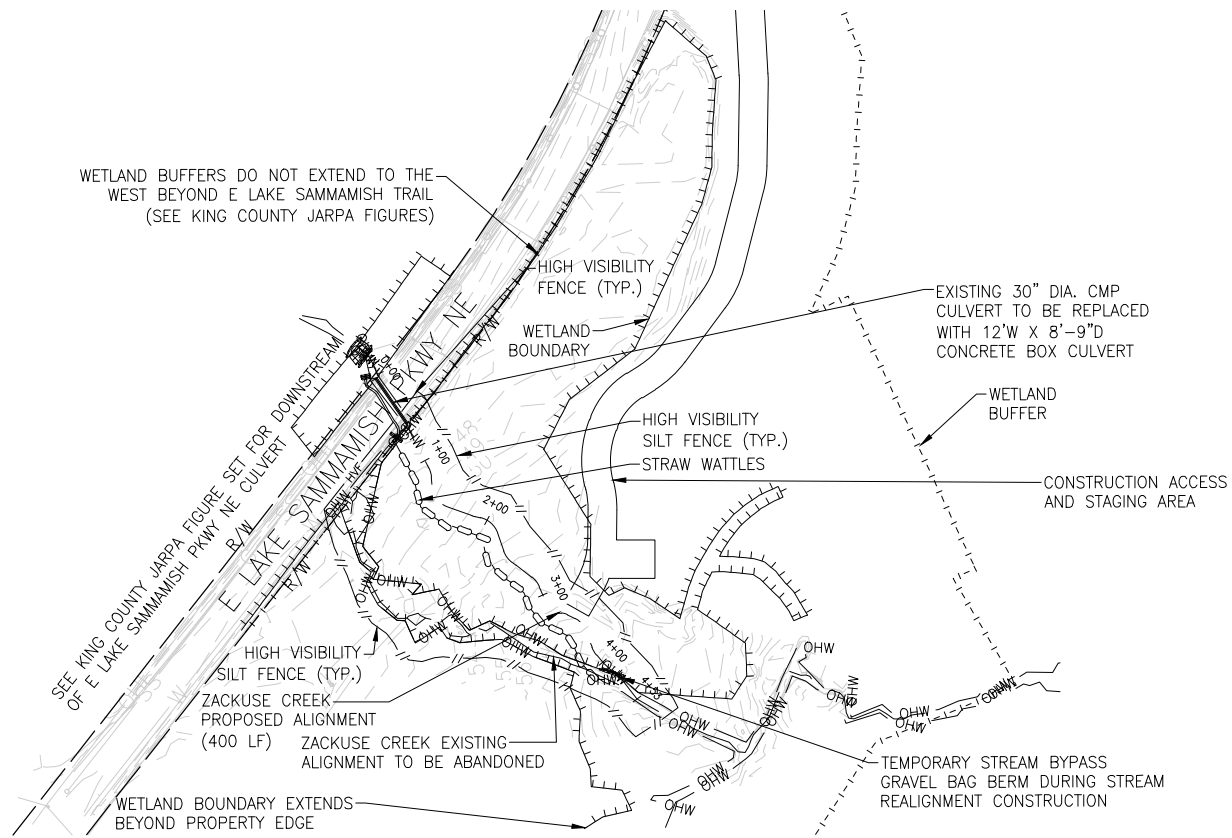

LEGEND

- | | | |
|--------------------------|--------------------------|-------------------------------------|
| +++++ WETLAND BOUNDARY | +++++ WETLAND BOUNDARY | ---//--- HIGH VISIBILITY SILT FENCE |
| - - - - - WETLAND BUFFER | - - - - - WETLAND BUFFER | o-o-o-o STRAW WATTLES |

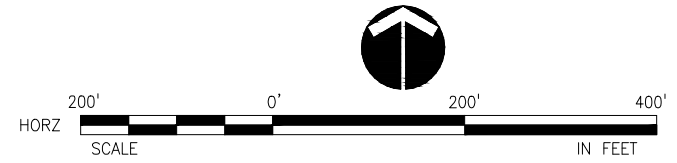

DATE: MAY 2017

APPLICANT: CITY OF SAMMAMISH

PURPOSE: ENVIRONMENTAL ENHANCEMENT

PROPOSED PROJECT: ZACKUSE CREEK FISH PASSAGE PROJECT

REFERENCE #:

LAT/LONG: 47.6100N / 122.0703W

ADJACENT PROPERTY OWNERS: SEE JARPA ATTACHMENT C

SITE LOCATION ADDRESS: PORTIONS OF SECTION 32, TOWNSHIP 25N, RANGE 06E

WATER BODY: LAKE SAMMAMISH/ZACKUSE CREEK
 NEAR: SAMMAMISH
 COUNTY: KING STATE: WA

SHEET 19: TEMPORARY EROSION AND SEDIMENT CONTROL (TESC) (2 OF 3)

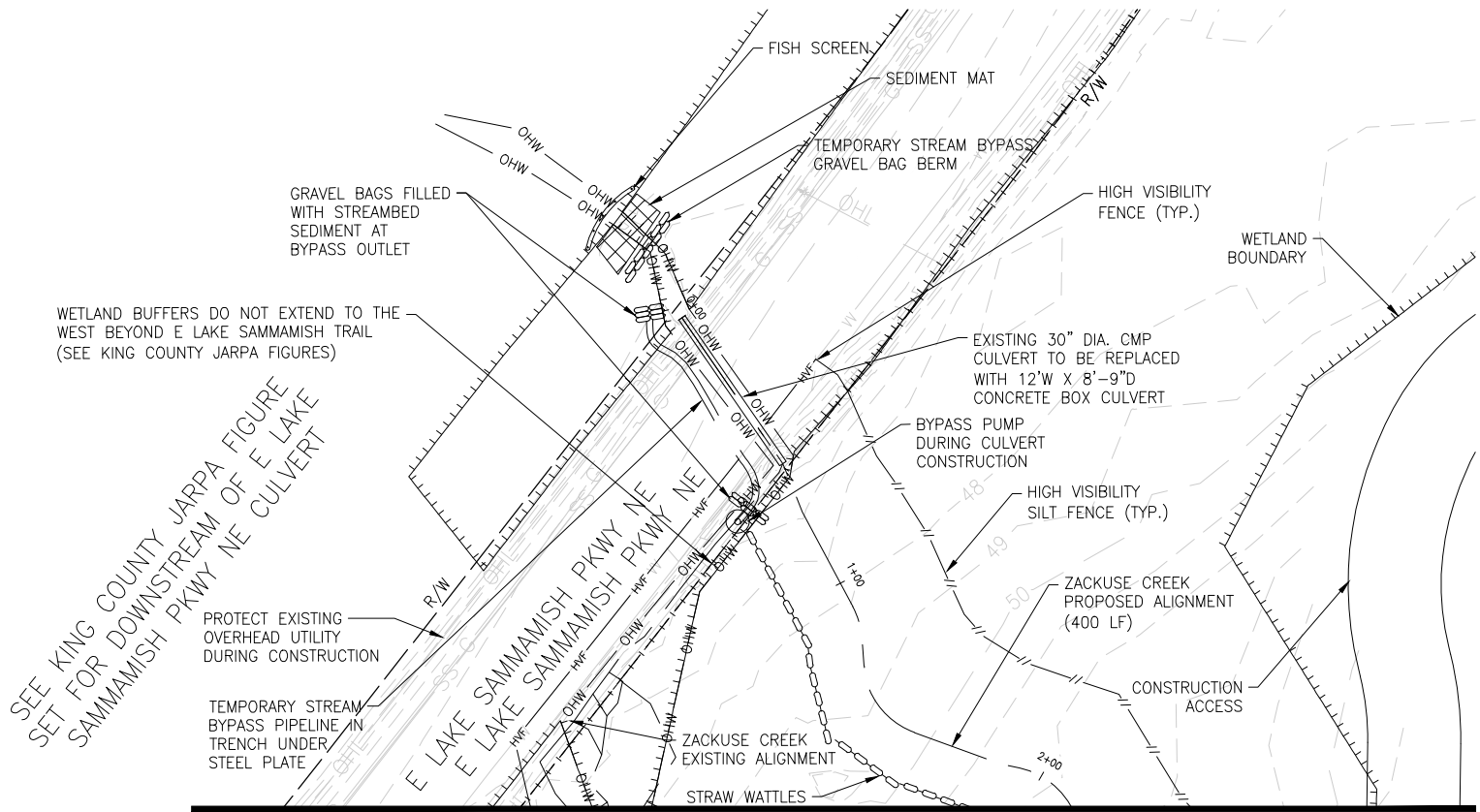

LEGEND

- WETLAND BOUNDARY
- - - - - WETLAND BUFFER
- WETLAND BOUNDARY
- - - - - WETLAND BUFFER
- ==//== HIGH VISIBILITY SILT FENCE
- o-o-o-o STRAW WATTLES

MATCH LINE SEE SHEET 20

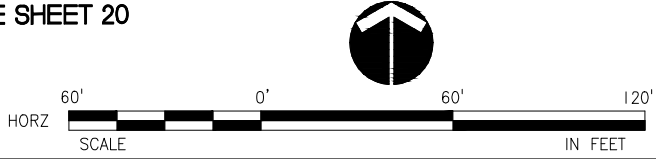

DATE: MAY 2017

APPLICANT: CITY OF SAMMAMISH

REFERENCE #:

ADJACENT PROPERTY OWNERS:
SEE JARPA ATTACHMENT C

PURPOSE: ENVIRONMENTAL ENHANCEMENT

LAT/LONG: 47.6100N / 122.0703W

SITE LOCATION ADDRESS:
PORTIONS OF SECTION 32,
TOWNSHIP 25N, RANGE 06E

PROPOSED PROJECT:
ZACKUSE CREEK FISH PASSAGE PROJECT

WATER BODY: LAKE SAMMAMISH/ZACKUSE CREEK
NEAR: SAMMAMISH

COUNTY: KING STATE: WA

19 OF 20

SHEET 20: TEMPORARY EROSION AND SEDIMENT CONTROL (TESC) (3 OF 3)

MATCH LINE SEE SHEET 19

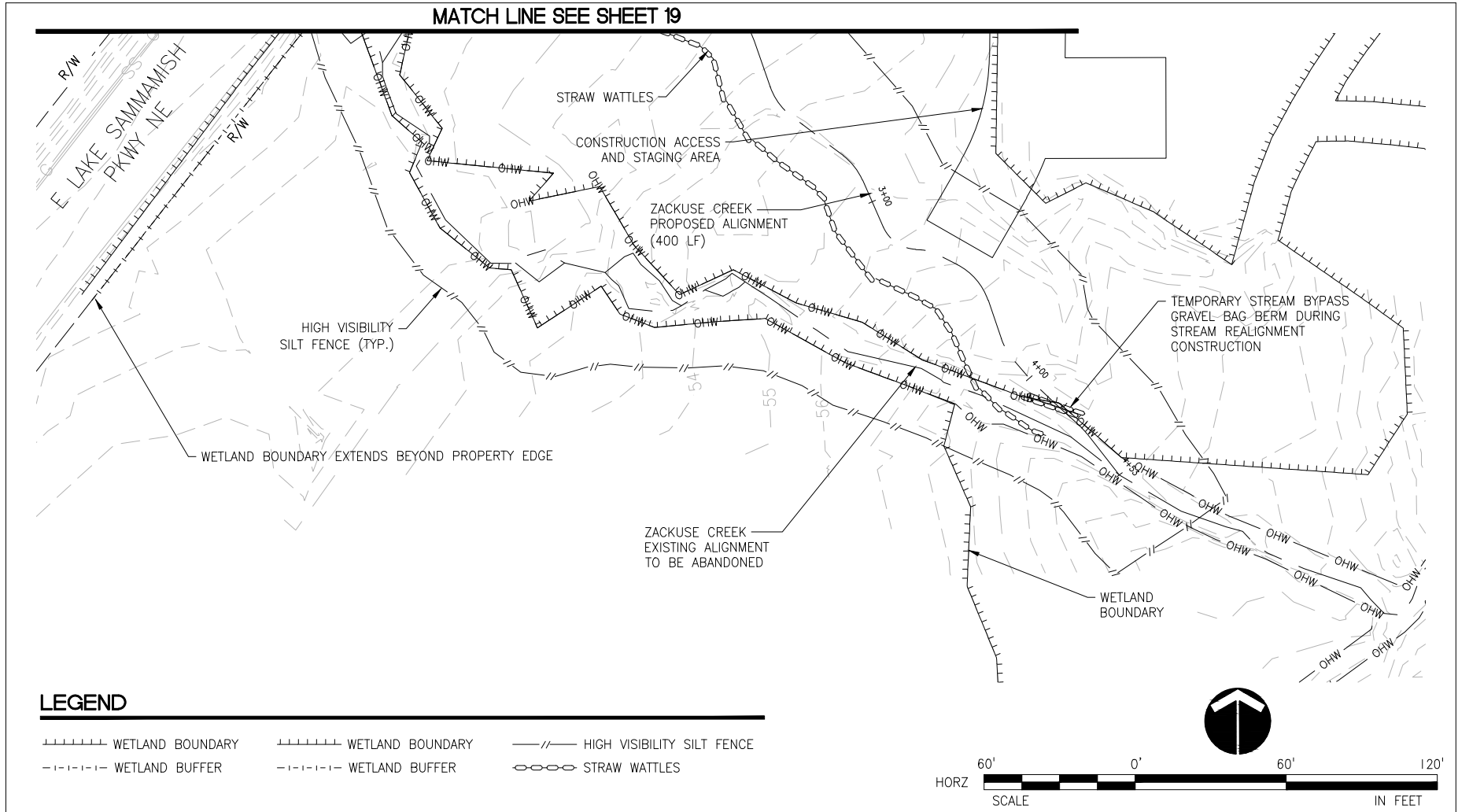

APPLICANT: CITY OF SAMMAMISH

REFERENCE #:

ADJACENT PROPERTY OWNERS:
 SEE JARPA ATTACHMENT C

PURPOSE: ENVIRONMENTAL
 ENHANCEMENT

LAT/LONG: 47.6100N / 122.0703W

SITE LOCATION ADDRESS:
 PORTIONS OF SECTION 32,
 TOWNSHIP 25N, RANGE 06E

PROPOSED PROJECT:
 ZACKUSE CREEK FISH PASSAGE PROJECT

WATER BODY: LAKE SAMMAMISH/ZACKUSE CREEK
 NEAR: SAMMAMISH

COUNTY: KING STATE: WA