



Community and Aquatic Center

City Council Presentation

Schematic Design

Workshop 3

June 11, 2013

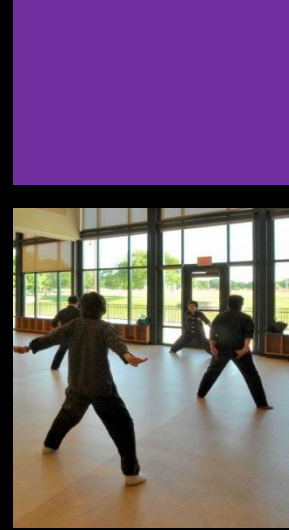

Agenda:

- a. Overall Project Update**
- b. Schedule, Budget and Program Overview**
- c. Review Site and Building Plan Progression**
- d. Building Character Preview**



Building Program

Summary:

	1	2	3	4
Program Space	Contract	YMCA	4-29-13 Program	Current Plan
Facility Admin	1,800	1,800	1,570	1,647
Building Support	6,500	8,000	9,836	16,400
Multi-Purpose	2,500	2,700	2,100	1,963
Child Watch/ Babysitting	1,300	1,300	1,300	1,269
Children's Indoor Playground	2,200	2,200	2,200	2,497
Gymnasium	11,670	7,500	8,500	7,920
Walk/ Jog Track	2,544			
Weight/ Fitness	7,300	8,000	7,300	8,100
Group Fitness	4,100	5,200	5,650	6,304
Natatorium	10,700	10,700	12,300	10,842
Projected Net Area:	57,000	53,786	50,756	57,002
Projected Total Area:	67,260	63,467	59,892	59,811



Site and Plan Studies

Project Budget

Building Cost =	\$14,100,000
Structured Parking Cost =	\$4,300,000
Site and Loop Road =	\$3,856,000
Soft Costs =	\$3,000,000
Sub Total =	\$25,256,000
- 9.5% Sales Tax =	\$2,038,000
Sub Total	\$27,294,000
- 10% Contingency =	\$2,729,000
Project Cost =	\$30,023,000

Existing Path

SCAC

Exist. Lot

City Hall

Elevator/ Stair

New Garage
~200 Spaces

Library





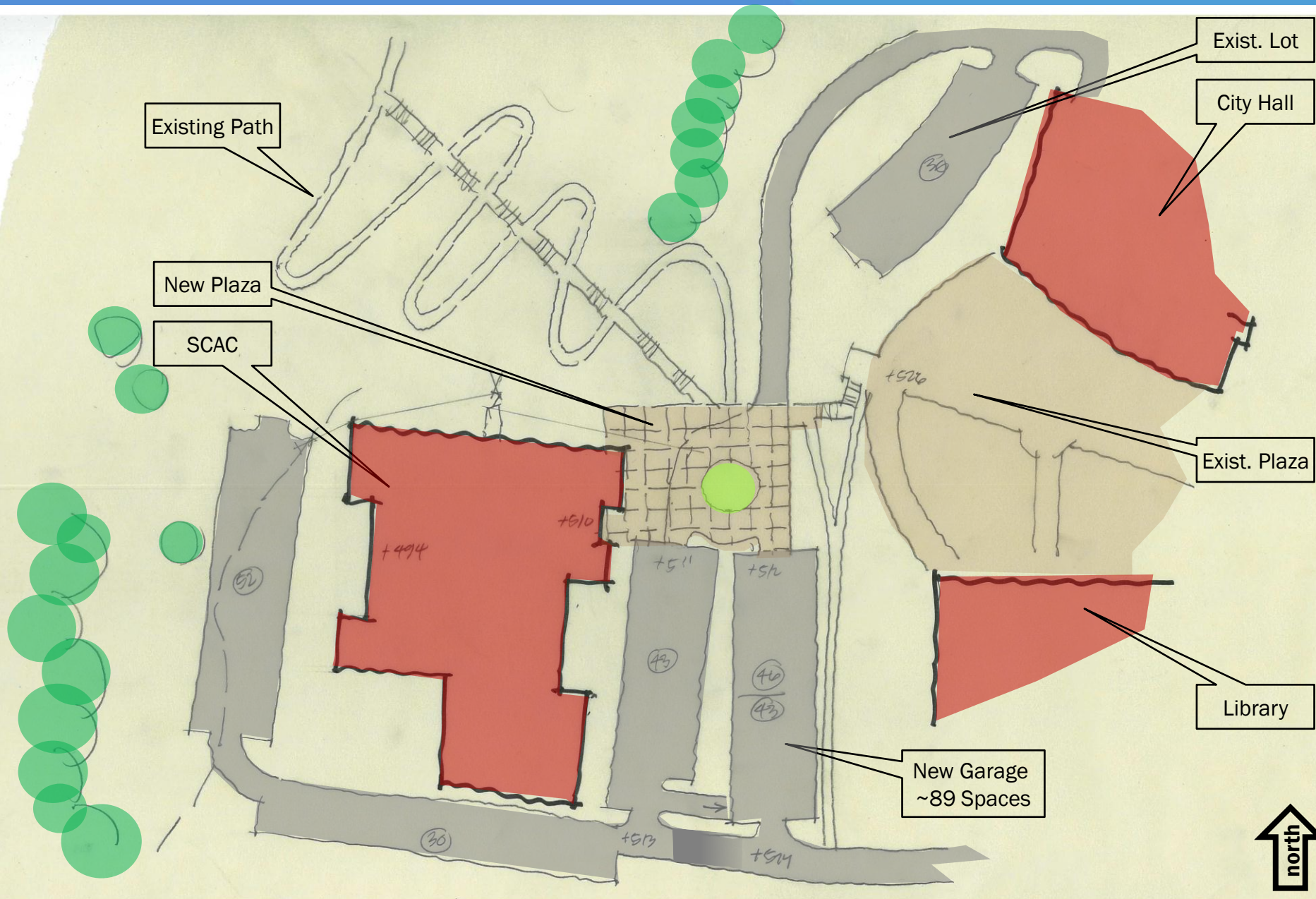

Site Plan



Future Aquatics expansion location

Auxiliary Gym expansion location

Community Aquatics Center

Main Entry Plaza

Structured Parking

City Hall

Library



Garage Strategy

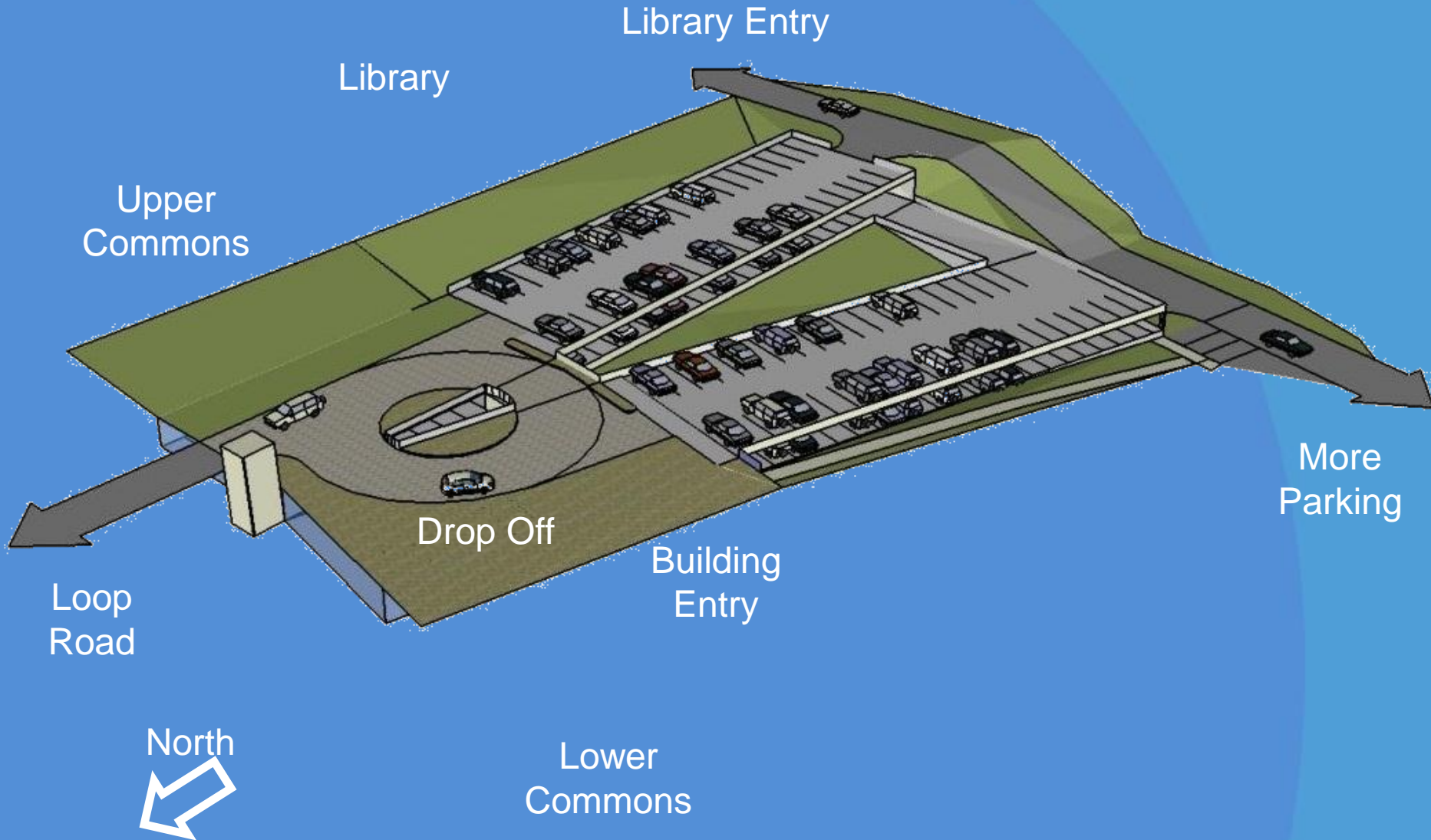

Garage Strategy

Lower Commons

Building Entry

Drop Off

Loop Road

More Parking

Upper Commons

Library

Library Entry

North





Building Design

Upper Level

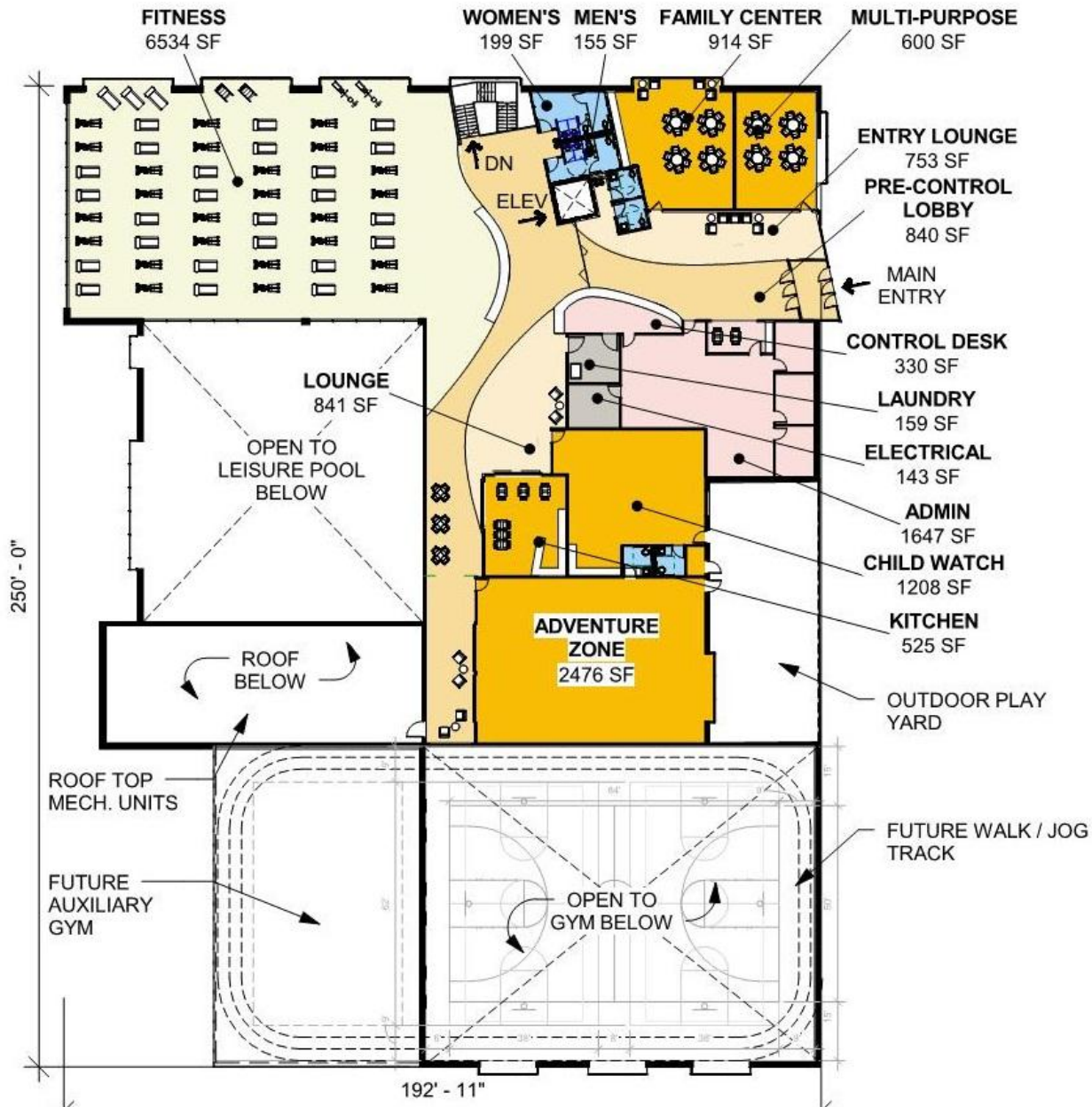

SD PROGRAM AREA

- Aquatics
- Athletics
- Circulation / Public
- Fitness
- Lockers / Restrooms
- Non-Public / Support
- Office / Admin



Upper Level

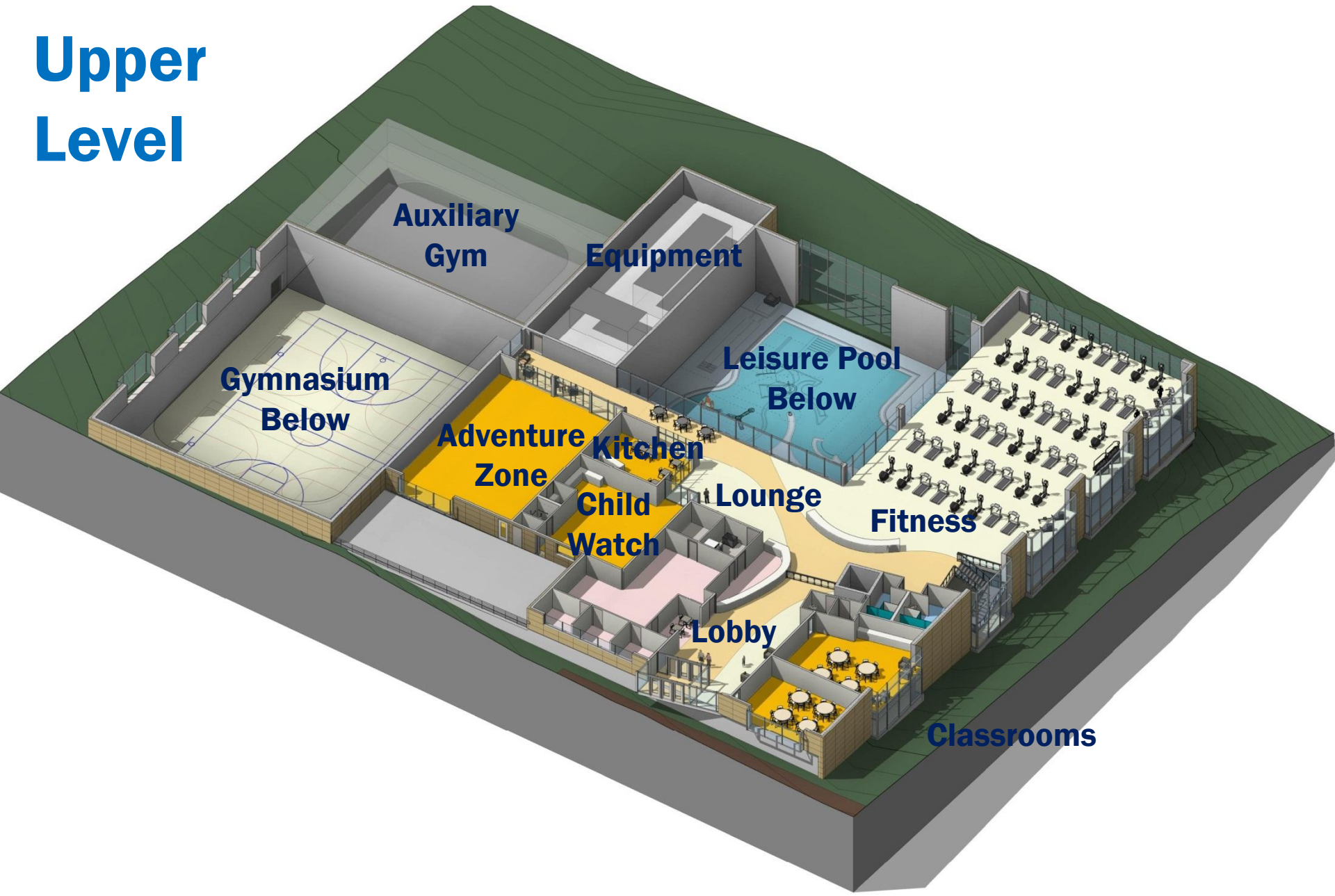

Upper Level

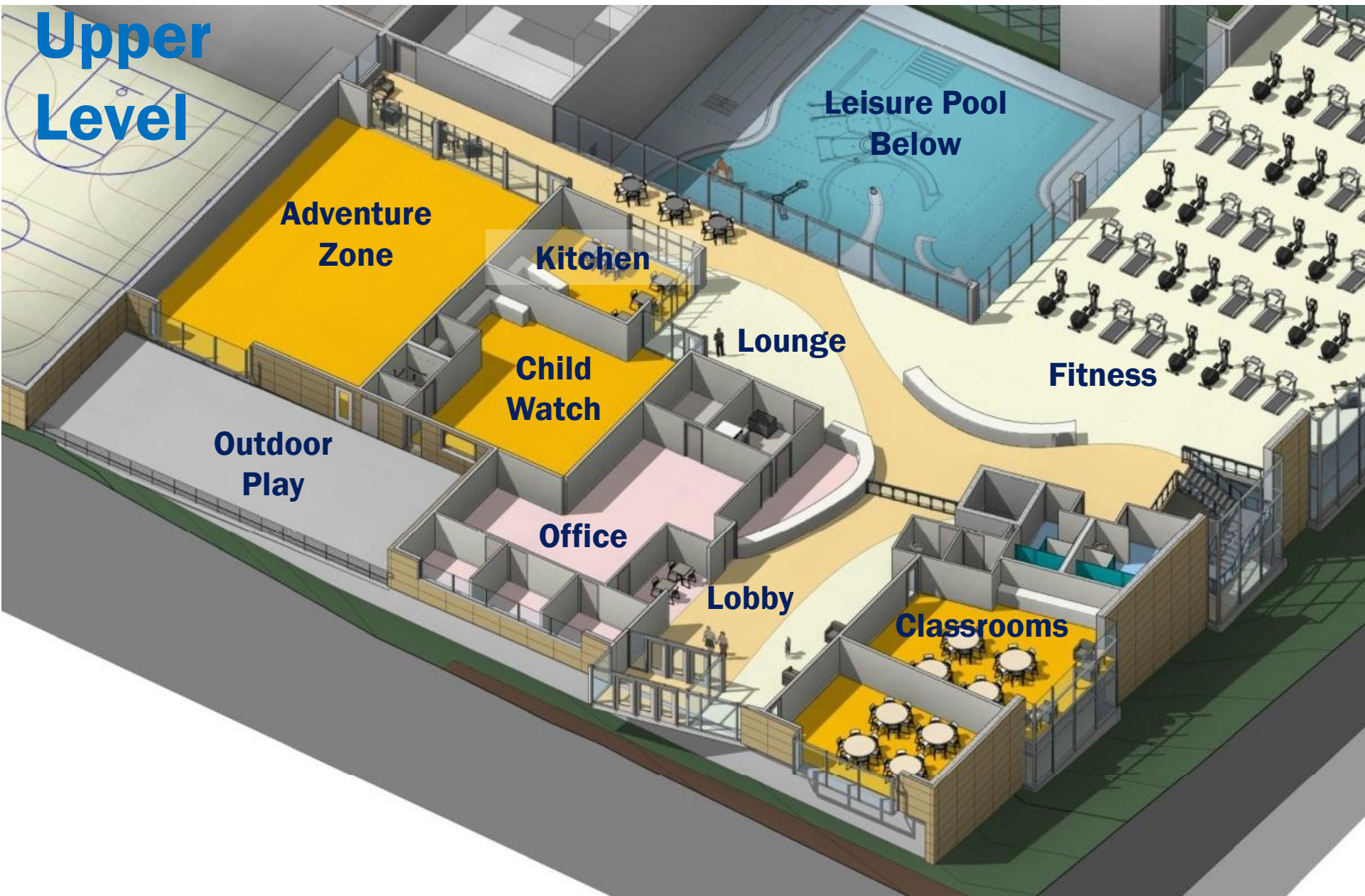

Adventure Zone

Kitchen

Leisure Pool Below

Fitness

Outdoor Play

Child Watch

Lounge

Office

Lobby

Classrooms

Upper Level

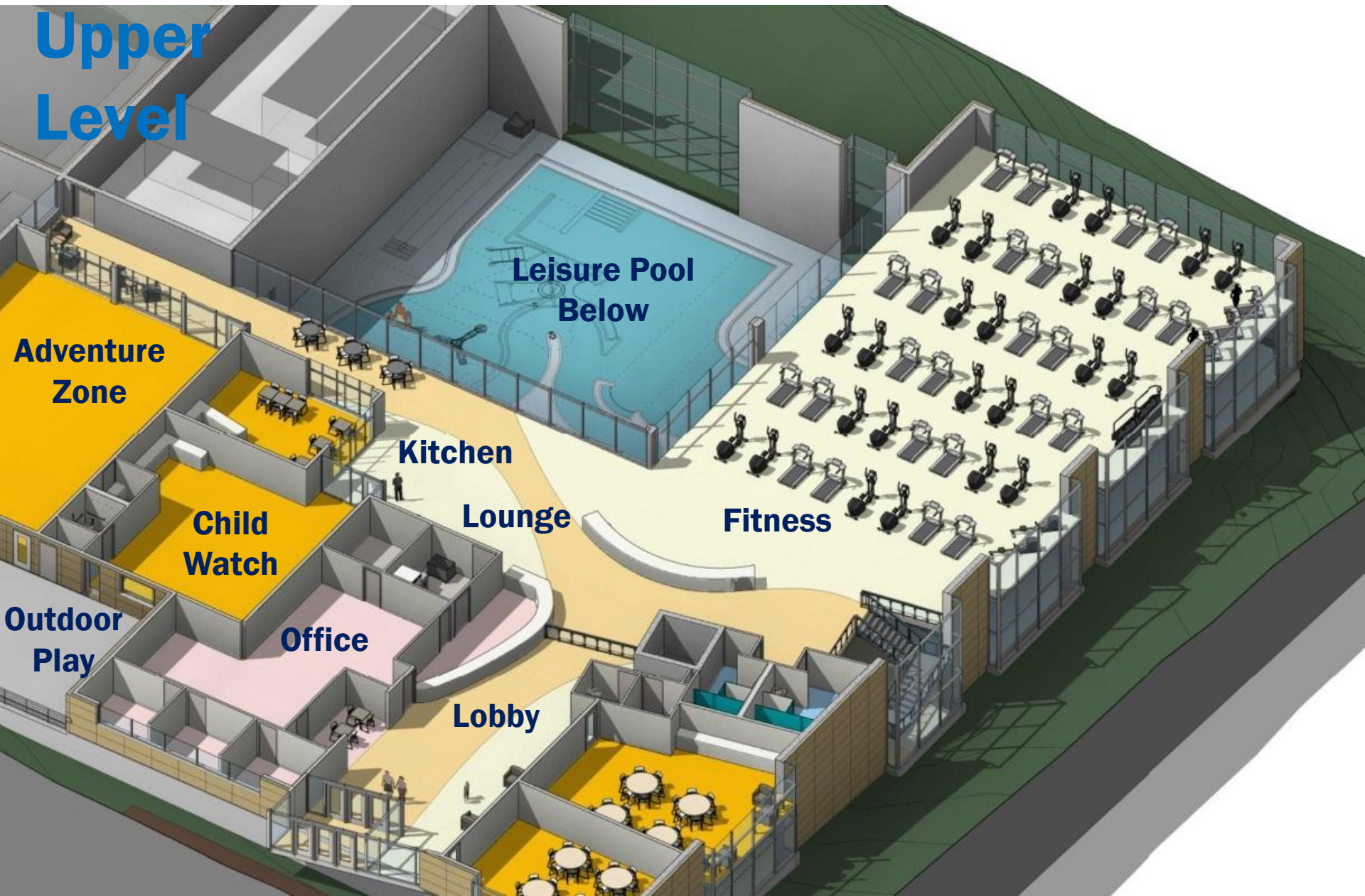

Leisure Pool Below

Adventure Zone

Kitchen

Fitness

Child Watch

Lounge

Office

Outdoor Play

Lobby

Upper Level



Lower Level

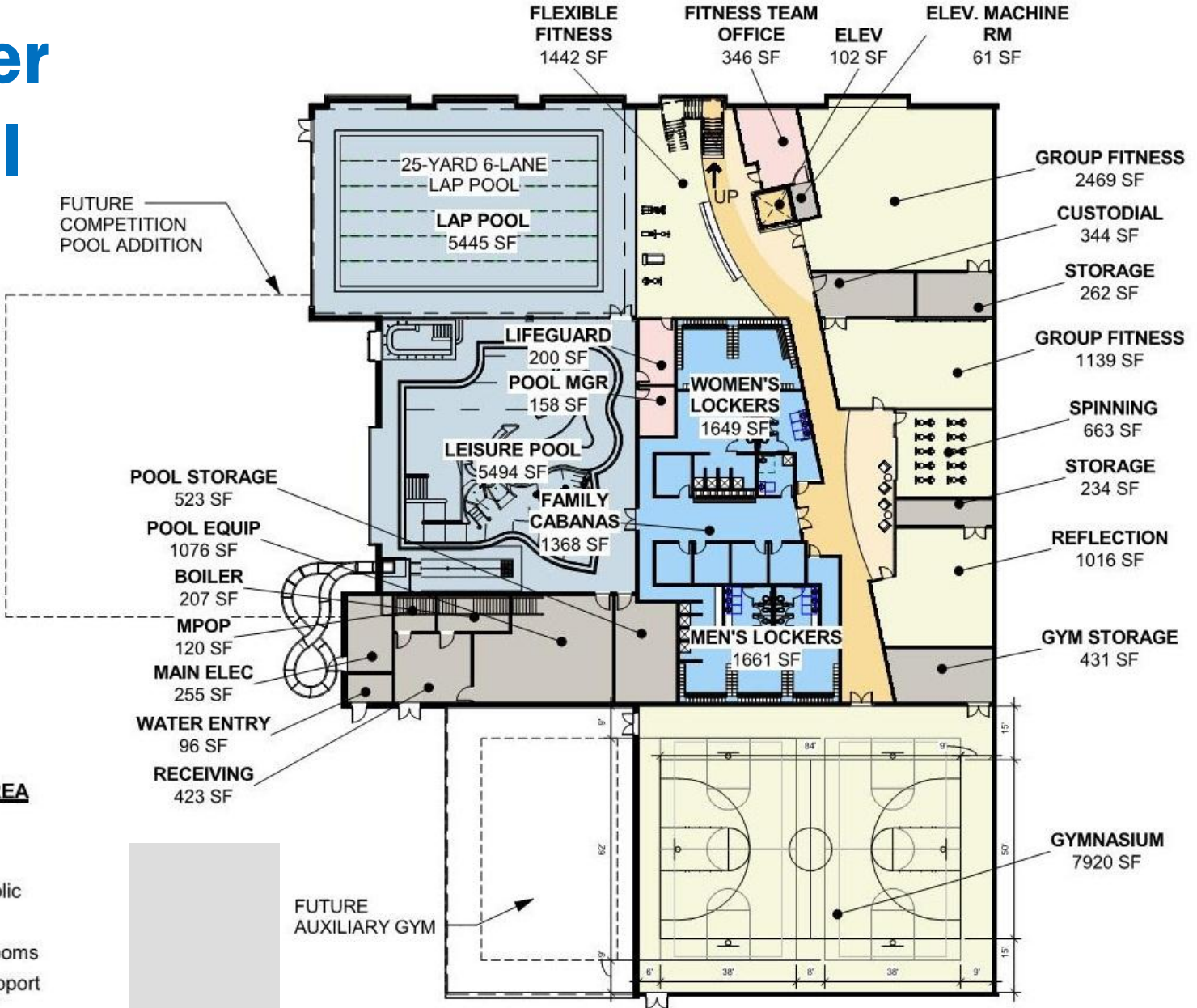

Lower Level

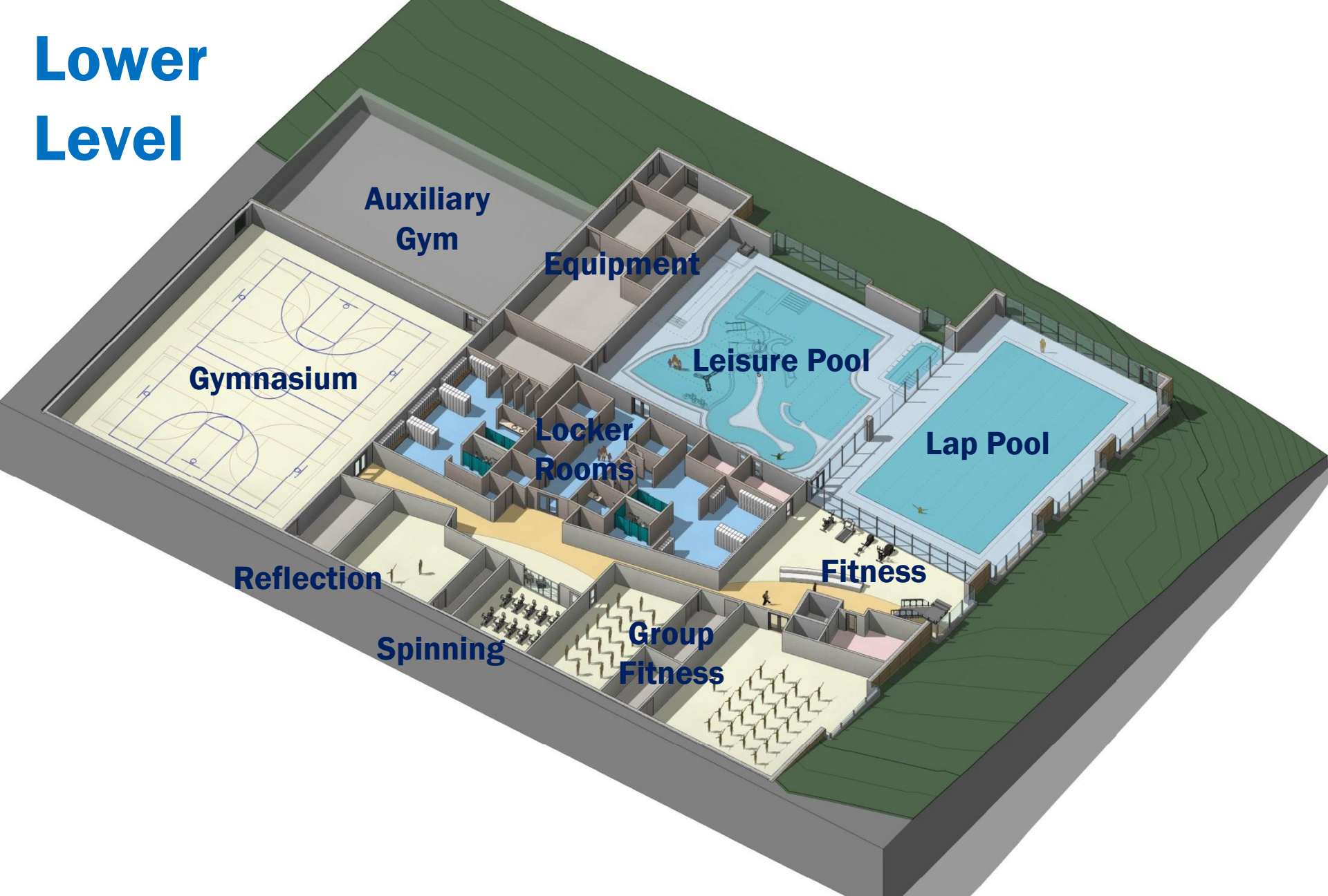

Lower Level

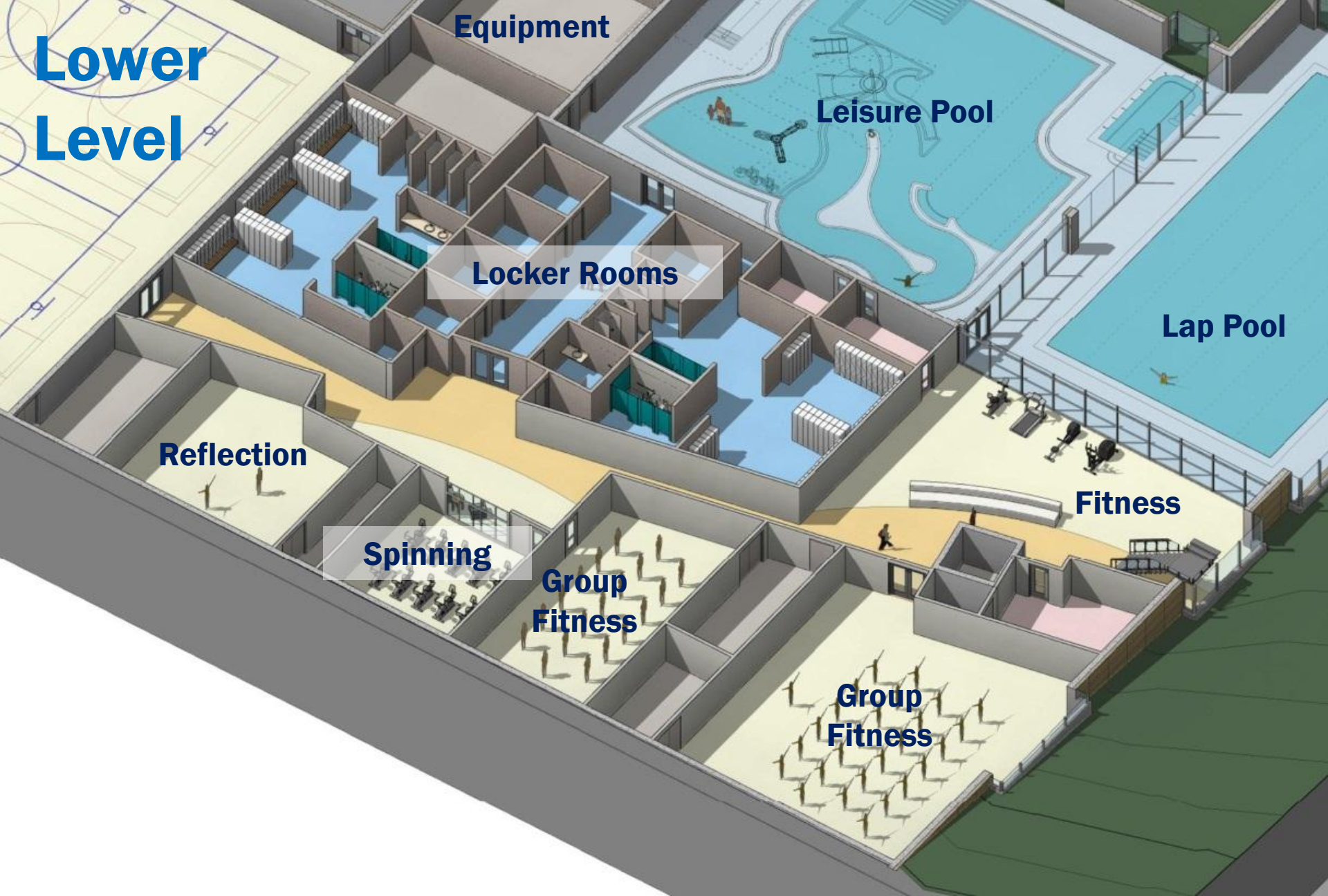

Equipment

Leisure Pool

Lap Pool

Locker Rooms

Reflection

Fitness

Spinning

Group Fitness

Group Fitness

Lower Level

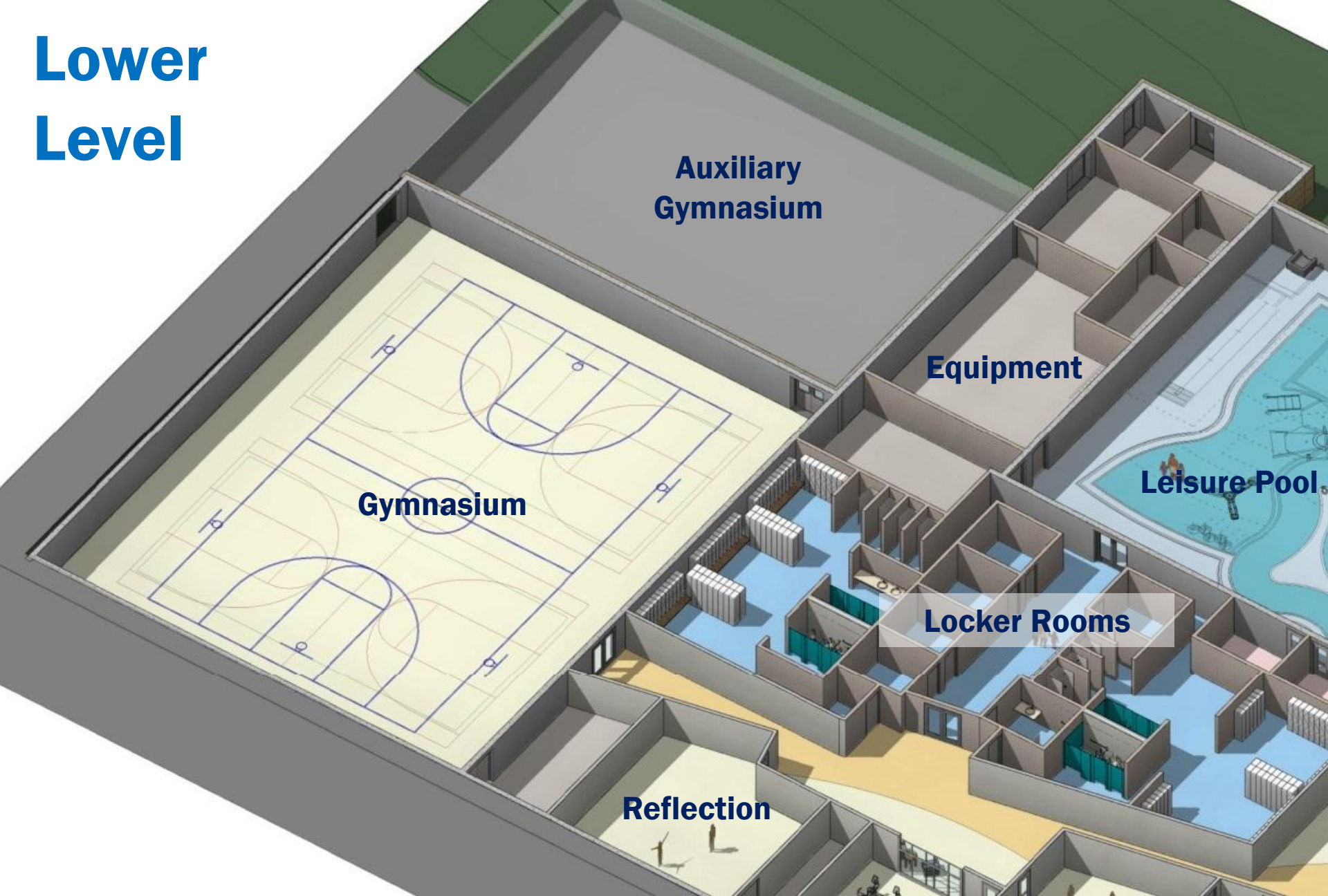

**Auxiliary
Gymnasium**

Gymnasium

Equipment

Leisure Pool

Locker Rooms

Reflection



Aquatic Program



Programming Perception

Programs – Watertainment - Social

Aquatic Components:

a. Spray Play

b. Play Amenities

- Transparent
- Play Structure
- Basketball
- Volleyball

c. Water Slide with Run-out

d. Bench Seating

e. Whirlpool



Super Pool Programmer

Zero Depth:

Program Plan

- Teaching
- Water Introduction



Lap Lanes:

Program Plan

- Aerobics
- Lap Swimming
- Competitive Training
- Teaching



Open Water:

Program Plan

- Teaching
- Social
- Activity
 - Volleyball
 - Basketball



Current Channel:

Program Plan

- Teaching
- Water walking
- Aquacise



Spray Play:



Play Amenities:



Water Slides with Run-outs:



Bench Seating:



Whirlpool:



Concept One:

- 6 Lane Lap Pool 3400 SF
- User Capacity 170
- Leisure Pool 2490 SF
- User Capacity 166
- Current Channel 100 LF
- Whirlpool 142 SF
- # Passengers 12

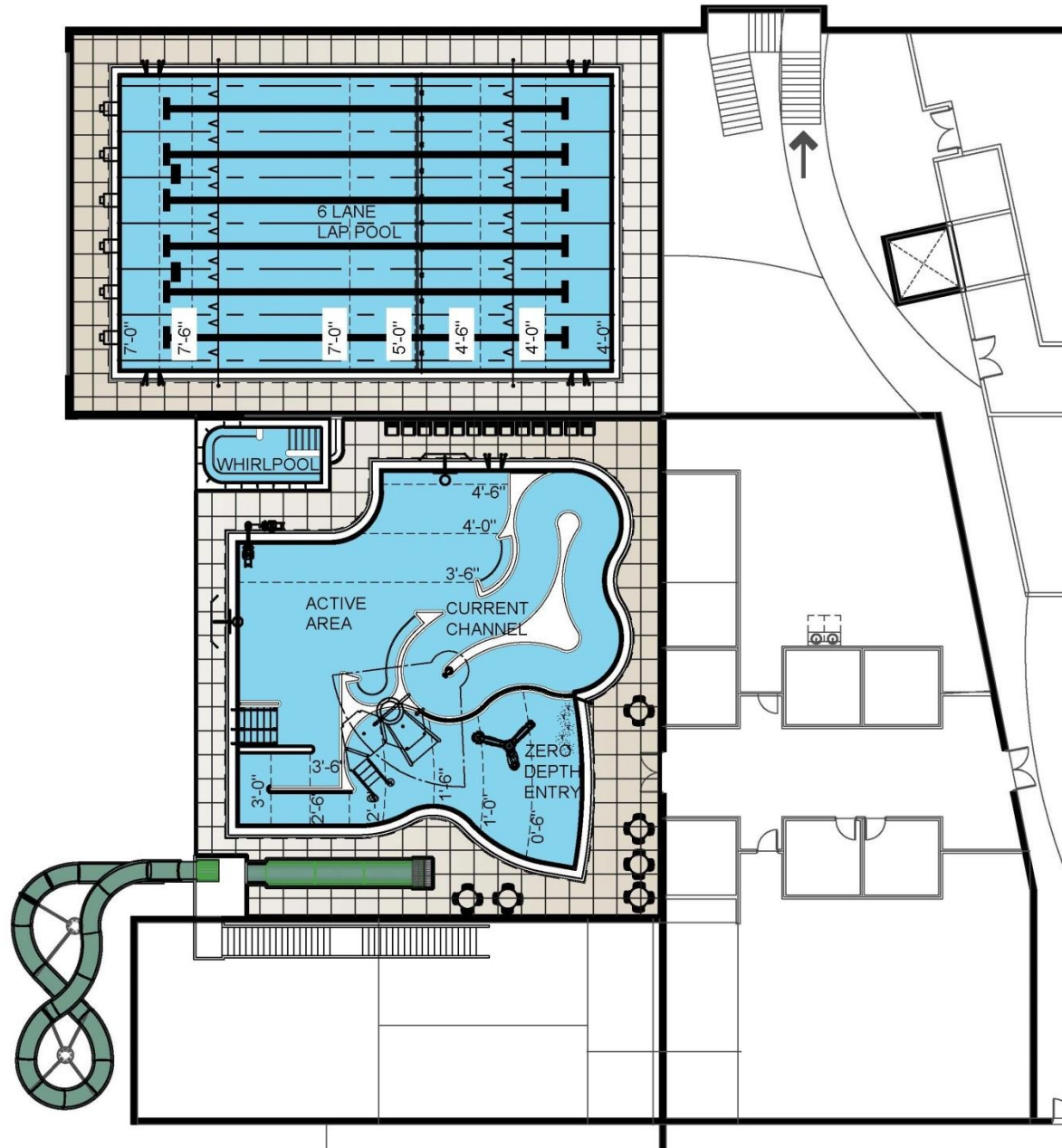

Concept One:

6 Lane Lap Pool 3400 SF
User Capacity 170
Leisure Pool 2490 SF
User Capacity 166
Current Channel 100 LF
Whirlpool 142 SF
Passengers 12

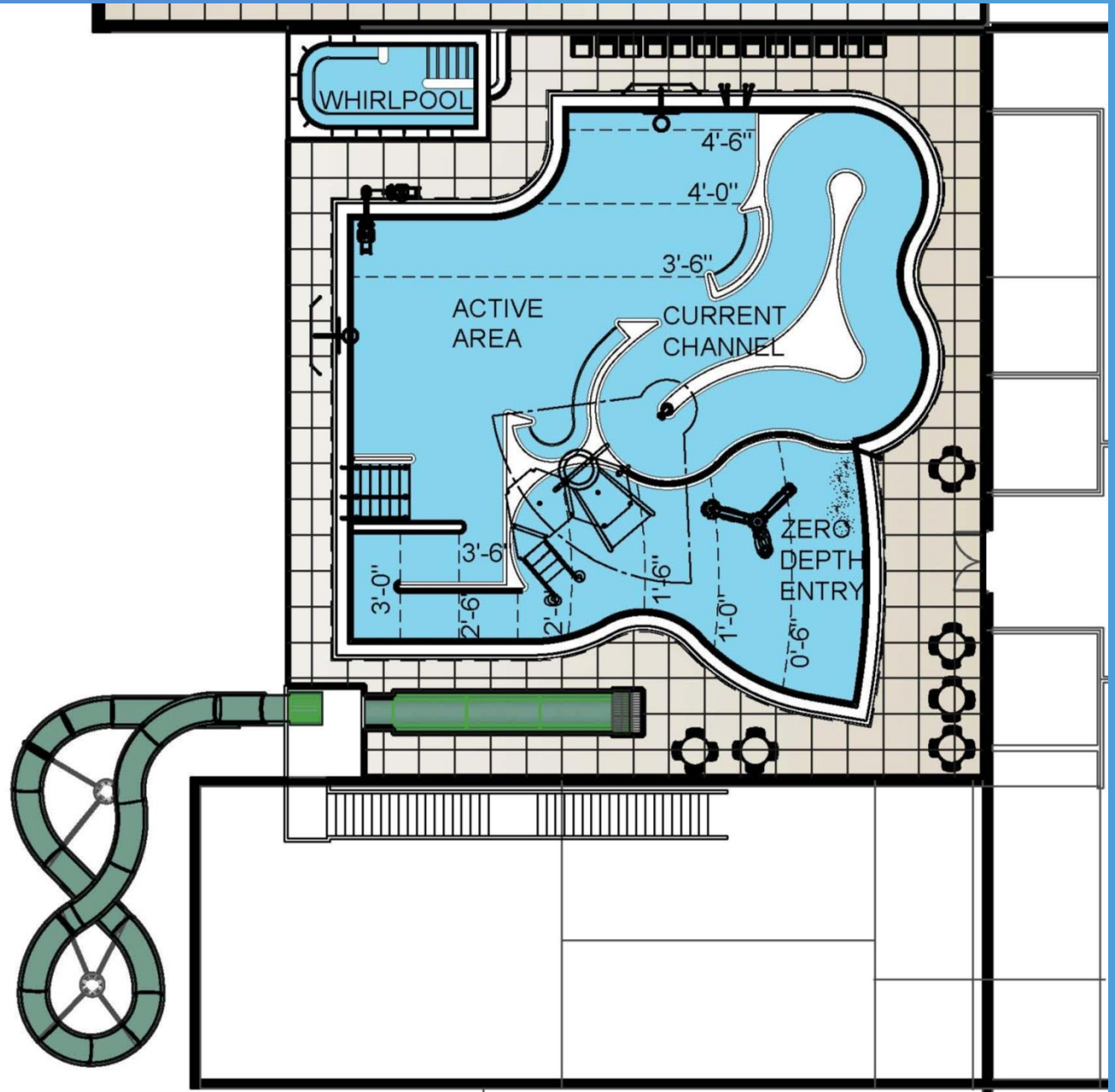

Concept Two:

- 6 Lane Lap Pool 3400 SF
- User Capacity 170
- Leisure Pool 2285 SF
- User Capacity 152
- Current Channel 141 LF
- Whirlpool 160 SF
- # Passengers 18

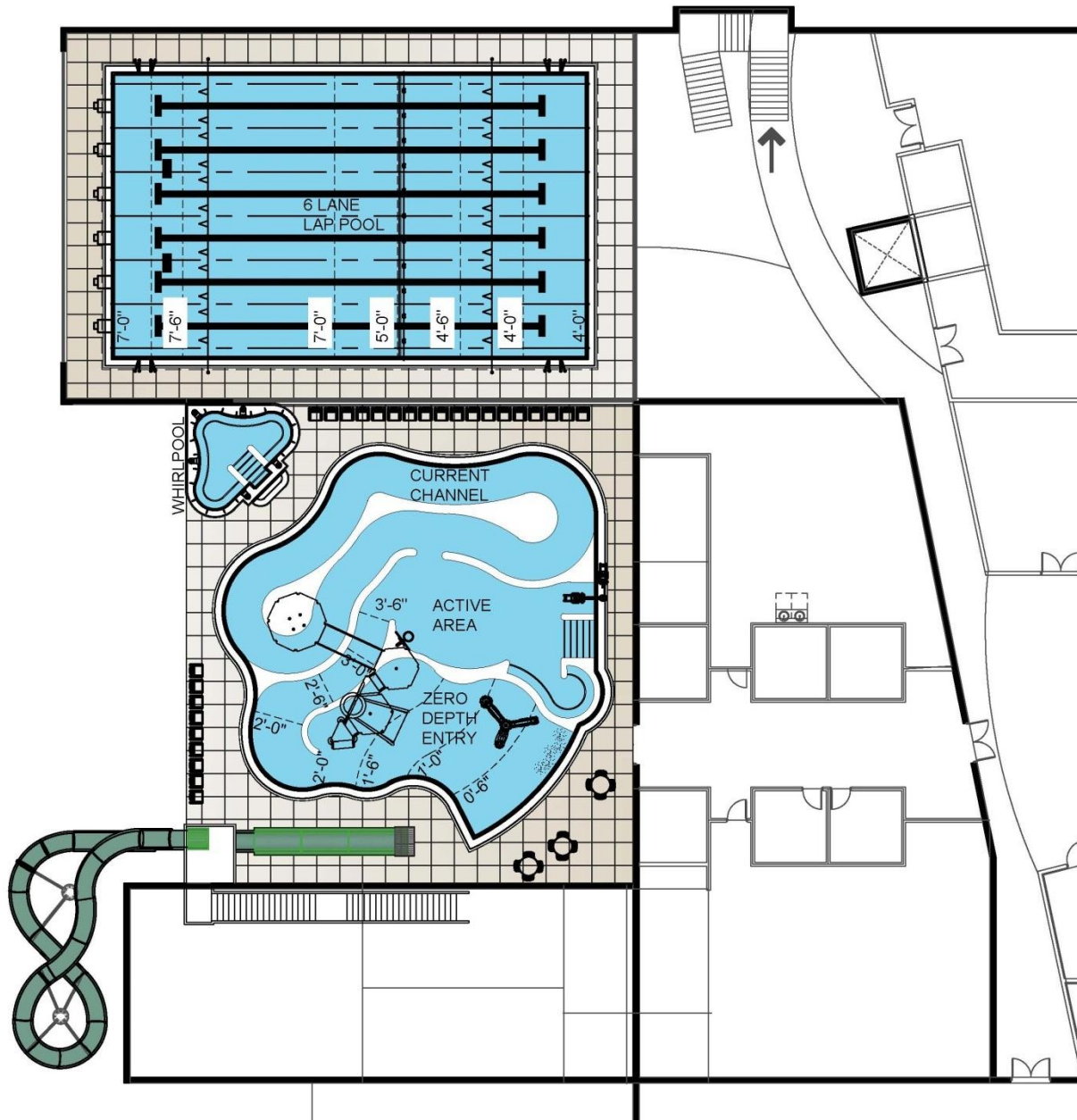

Concept Two:

6 Lane Lap Pool 3400 SF
User Capacity 170
Leisure Pool 2285 SF
User Capacity 152
Current Channel 141 LF
Whirlpool 160 SF
Passengers 18

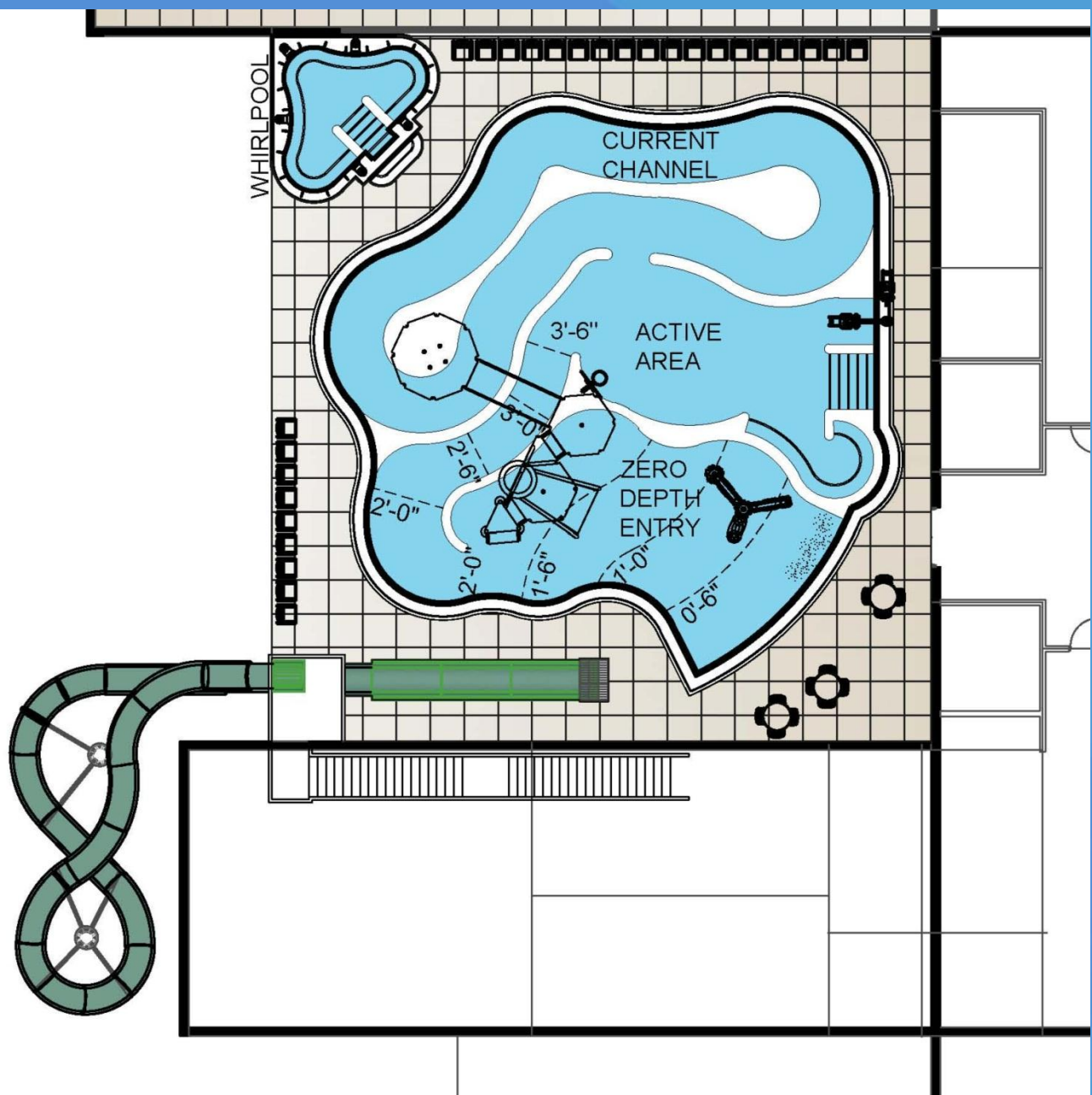

Detail Comparisons:

	Option 1	Option 2
6 Lane Lap Pool	3400 SF	3400 SF
User Capacity	170	170
Leisure Pool	2490 SF	2285 SF
User Capacity	166	152
Current Channel	100 LF	141 LF
Whirlpool	142 SF	160 SF
# Passengers	12	18



Thoughts